

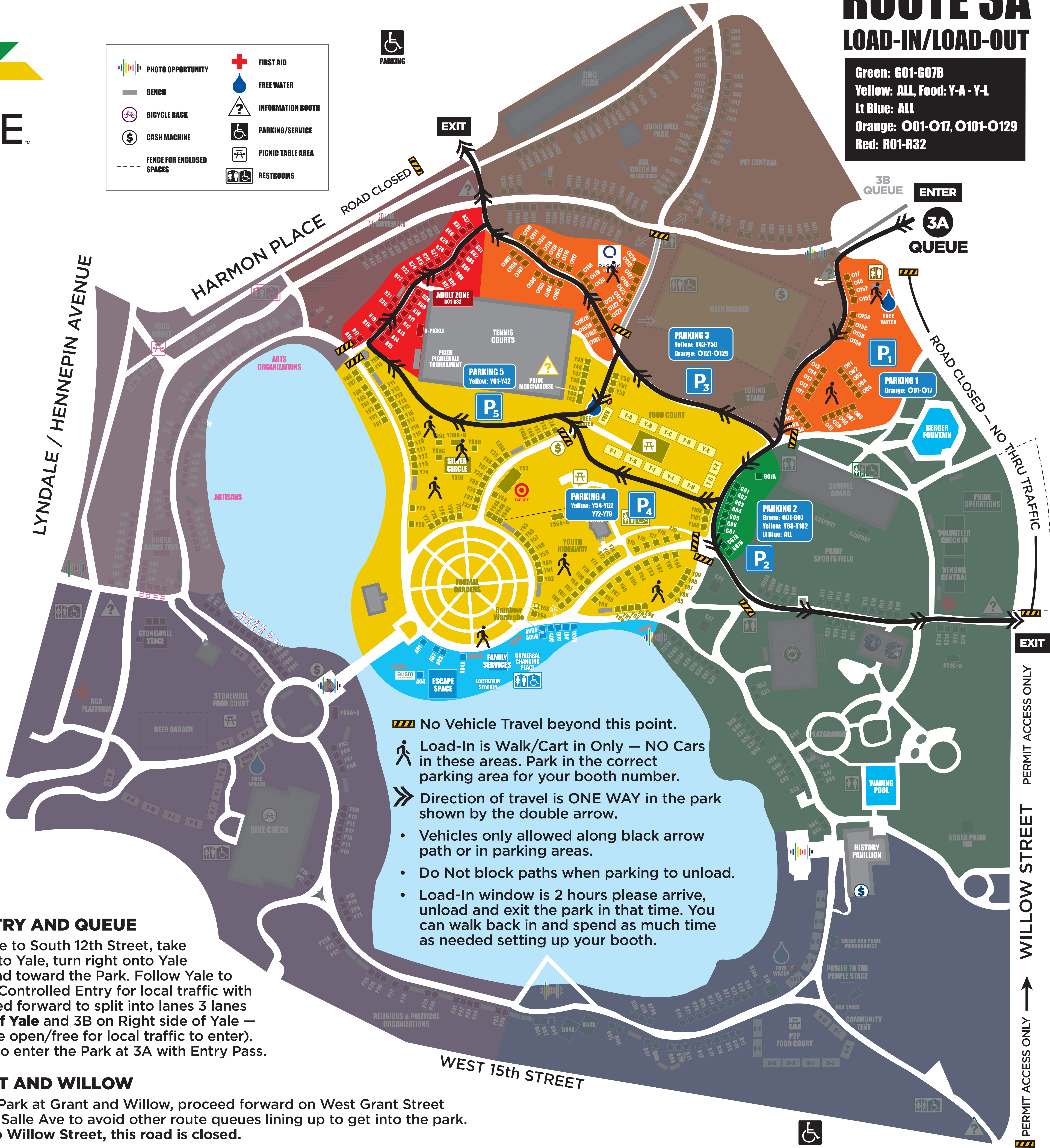

ROUTE 3A LOAD-IN/LOAD-OUT

Green: G01-G07B
 Yellow: ALL, Food: Y-A - Y-L
 Lt Blue: ALL
 Orange: O01-O17, O101-O129
 Red: R01-R32

	PHOTO OPPORTUNITY		FIRST AID
	BENCH		FREE WATER
	BICYCLE RACK		INFORMATION BOOTH
	CASH MACHINE		PARKING/SERVICE
	FENCE FOR ENCLOSED SPACES		PICNIC TABLE AREA
			RESTROOMS



- No Vehicle Travel beyond this point.
- Load-In is Walk/Cart in Only — NO Cars in these areas. Park in the correct parking area for your booth number.
- Direction of travel is ONE WAY in the park shown by the double arrow.
 - Vehicles only allowed along black arrow path or in parking areas.
 - Do Not block paths when parking to unload.
 - Load-In window is 2 hours please arrive, unload and exit the park in that time. You can walk back in and spend as much time as needed setting up your booth.

ROUTE 3A ENTRY AND QUEUE

Take Hennepin Ave to South 12th Street, take South 12th Street to Yale, turn right onto Yale heading westbound toward the Park. Follow Yale to Spruce and enter Controlled Entry for local traffic with Entry Pass, proceed forward to split into lanes 3 lanes (3A on Left side of Yale and 3B on Right side of Yale — leaving center lane open/free for local traffic to enter). Proceed forward to enter the Park at 3A with Entry Pass.

EXIT AT GRANT AND WILLOW

When exiting the Park at Grant and Willow, proceed forward on West Grant Street until you get to LaSalle Ave to avoid other route queues lining up to get into the park. **DO NOT** turn onto Willow Street, this road is closed.

WILLOW STREET PERMIT ACCESS ONLY

