

2025 Twin Cities Pride Festival

This deck, route maps, and recordings of sessions
available at <https://tcpride.org/2025vendorinfo/>

Vendor Load-in



Load-in Meetings: May 22, 25 & 28 2025

Festival Dates: June 27-29, 2025



Derrick Strom (He/Him)

Event Vendor Manager
derrick.strom@tcpride.org



Contents:

2025 Twin Cities Pride Festival

01

Festival Details

02

Packet Pick-up

03

**Vendor Integrity Team &
Code of Conduct**

04

Safety Briefing

05

Festival Maps

06

Vendor Setup

07

Load-In & Load-Out

08

Route Maps & Queues

**LIVE
PROUD**



2025 Twin Cities Pride Festival

Event Vendor Team



Derrick Strom (he/him)
Event Vendor Manager



Emily Sears (she/her)
Event Vendor Coordinator



Sarah Barnett (she/her)
Event Vendor Coordinator



Alexei Dickinson (he/him)
Event Vendor Coordinator



Mitch Markgraf (he/him)
Food Vendor Manager



Ed "the Admiral" (he/him)
Vendor & Load-in Lead



**Moxii (Sarah Severson)
(she/her)**
Load-in Coordinator



Erin Kelly (she/her)
Load-in Coordinator



Steve Tripp (he/him)
Load-in Coordinator



Cory Hilden (she/her)
Events Logistic Director



Braeden Johnson (he/him)
Health & Safety Director
Vendor Integrity Manager



2025 Twin Cities Pride Festival

Vendor Integrity Team



Braeden Johnson (he/him)
Health & Safety Director
Vendor Integrity Manager



Nick Hengel (he/him)
Vendor Integrity Coordinator



Madison Greenwaldt (she/her)
Vendor Integrity Coordinator



Andi Otto (he/him)
Executive Director



Derrick Strom (he/him)
Event Vendor Manager



Mitch Markgraf (he/him)
Food Vendor Manager



ALL VENDORS



2025 FESTIVAL INFORMATION

<https://tcpride.org/2025vendorinfo/>
<https://tcpride.org/festival/>

- Interactive, Accessibility & PDF Maps
- Vendor Meeting Decks & Recordings
- **Route & Queue Maps**
- FAQs

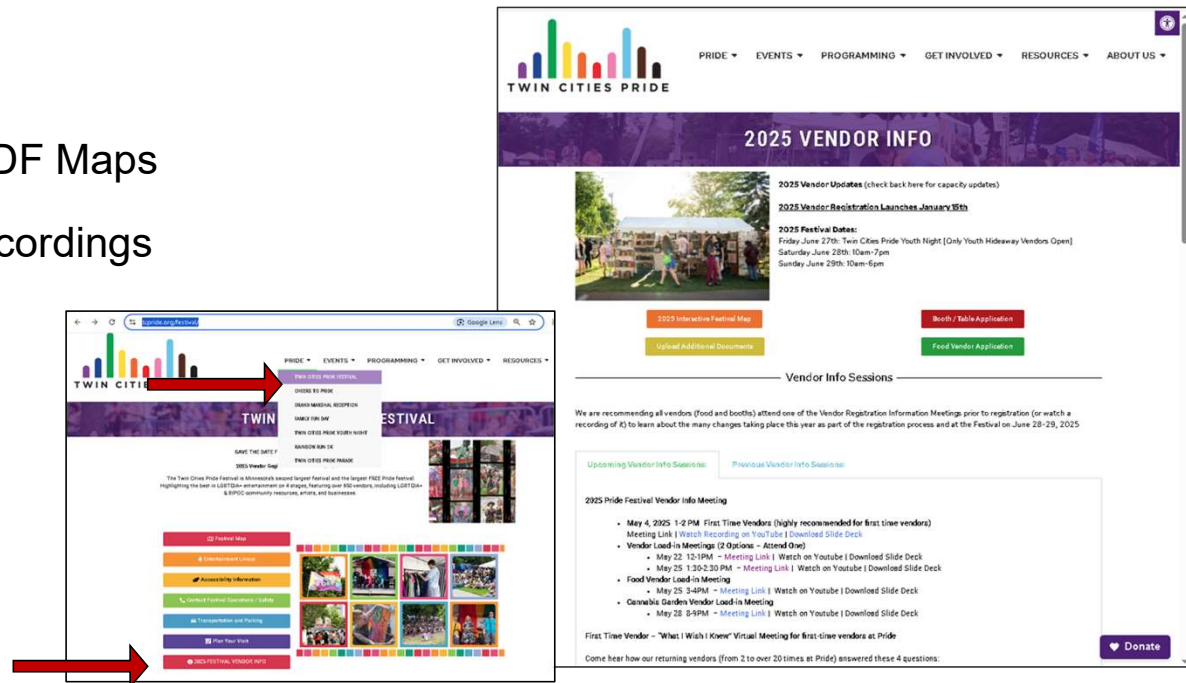

LIVE
PROUD



2025 Twin Cities Pride Festival

Hours of Operations

Load-In / Set-up

June 26 & 27, 2025 in Loring Park

26th - Thursday Time Slots

- Morning Food Vendors (19)
- Morning Booth Vendors (24)
- Afternoon Food Vendors (12)
- Afternoon Booth Vendors (47)

27th - Friday Time Slots

- 7-9 AM Food Vendors (3)
- 9-11 AM Booth Vendors (137)
- 11-1 PM Booth Vendors (116)
- 1-3 PM Booth Vendors (138)

All vendor set up ends & exit park by 3 PM Friday

Operations:

June 27-29, 2025 in Loring Park

- 4 PM - 8 PM FRIDAY 27th Youth Night (select vendors)
- 10 AM - 7 PM SATURDAY 28th
- 10 AM - 6 PM SUNDAY 29th
 - 9 AM Faith Services



2025 Twin Cities Pride Festival Theme



The theme "Live Proud" celebrates self-acceptance, visibility, and resilience. It encourages individuals to embrace their identities and express themselves authentically, fostering a sense of community and solidarity among LGBTQ+ individuals and allies. Overall, "Live Proud" is a powerful call to embrace one's identity, advocate for equality, and celebrate the beauty of diversity within the LGBTQ+ community.



2025 Twin Cities Pride Festival

Social Templates



Templates available at:

<https://tcpride.org/2025vendorinfo/>



Proof of Liability Insurance (COI)

- Must be a Certificate of Liability Insurance
- Must be valid during all dates of the festival
- Must have at least \$1,000,000 of coverage
- Coverage must be General Liability
- Must list Twin Cities Pride as an additional insured (with current address)

ACORD **CERTIFICATE OF LIABILITY INSURANCE** DATE (MM/DD/YYYY) 03/17/2023

THIS CERTIFICATE IS ISSUED AS A MATTER OF INFORMATION ONLY AND CONFERS NO RIGHTS UPON THE CERTIFICATE HOLDER. THIS CERTIFICATE DOES NOT AFFIRMATIVELY OR NEGATIVELY AMEND, EXTEND OR ALTER THE COVERAGE AFFORDED BY THE POLICIES BELOW. THIS CERTIFICATE OF INSURANCE DOES NOT CONSTITUTE A CONTRACT BETWEEN THE ISSUING INSURER(S), AUTHORIZED REPRESENTATIVE OR PRODUCER, AND THE CERTIFICATE HOLDER.

IMPORTANT: If the certificate holder is an ADDITIONAL INSURED, the policy(ies) must be endorsed. If SUBROGATION IS WAIVED, subject to the terms and conditions of the policy, certain policies may require an endorsement. A statement on this certificate does not confer rights to the certificate holder in lieu of such endorsement(s).

PRODUCER CONTACT NAME:

INSR LTR	TYPE OF INSURANCE	ADDITIONAL SUBROGATION	POLICY NUMBER	POLICY EFFECTIVE DATE (MM/DD/YYYY)	POLICY EXPIRATION DATE (MM/DD/YYYY)	COVERAGE	AMOUNT
A	<input checked="" type="checkbox"/> COMMERCIAL GENERAL LIABILITY	N N	0001075569	11/09/2023	11/09/2024	EACH OCCURRENCE	\$ 1,000,000
	<input type="checkbox"/> CLAIMS-MADE <input checked="" type="checkbox"/> OCCUR					DAMAGE TO RENTED EQUIPMENT (Each occurrence)	\$ 100,000
						DELETED EXP (Any one person)	\$ 5,000
						PERSONAL & ADV INJURY	\$ 1,000,000
	GEN'L AGGREGATE LIMIT APPLIES PER:					GENERAL AGGREGATE	\$ 2,000,000
	<input checked="" type="checkbox"/> POLICY <input type="checkbox"/> PROJECT <input type="checkbox"/> LOC				PRODUCTS - COMP/OP AGG	\$ 2,000,000	
	OTHER:					Fire Legal Liability	\$

DESCRIPTION OF OPERATIONS / LOCATIONS / VEHICLES (ACORD 101, Additional Remarks Schedule, may be attached if more space is required)
Twin Cities Pride, 1618 Harmon Place, Minneapolis, MN 55403. and Fanfare Attractions, 1215 East 22nd St, Minneapolis, MN 55404 are included as Additional Insured as required by written contract or agreement limited to the General Liability and Umbrella Liability coverages.

OR

CERTIFICATE HOLDER	CANCELLATION
Twin Cities Pride 1618 Harmon Place Minneapolis MN 55403	SHOULD ANY OF THE ABOVE DESCRIBED POLICIES BE CANCELLED BEFORE THE EXPIRATION DATE THEREOF, NOTICE WILL BE DELIVERED IN ACCORDANCE WITH THE POLICY PROVISIONS.
	AUTHORIZED REPRESENTATIVE

ACORD 25 (2016/03)

The ACORD name and logo are registered marks of ACORD

© 1988-2015 ACORD CORPORATION. All rights reserved.





Proof of Liability Insurance (COI)

Example of a **VALID** COI:

ACORD **CERTIFICATE OF LIABILITY INSURANCE** REPRO-1 OP ID: CV DATE: 05/09/2022

THIS CERTIFICATE IS ISSUED AS A MATTER OF INFORMATION ONLY AND CONFERS NO RIGHTS UPON THE CERTIFICATE HOLDER. THIS CERTIFICATE DOES NOT AFFIRMATIVELY OR NEGATIVELY AWARD, EXTEND OR ALTER THE COVERAGE AFFORDED BY THE POLICIES BELOW. THIS CERTIFICATE OF INSURANCE DOES NOT CONSTITUTE A CONTRACT BETWEEN THE ISSUING INSURER(S), AUTHORIZED REPRESENTATIVE OR PRODUCER, AND THE CERTIFICATE HOLDER.

IMPORTANT: If the certificate holder is an ADDITIONAL INSURED, the policy(ies) must have ADDITIONAL INSURED provisions or be endorsed; if SUBROGATION is WAIVED, subject to the terms and conditions of the policy, certain policies may require an endorsement. A statement on this certificate does not confer rights to the certificate holder in lieu of such endorsement(s).

PRODUCER: JAL TITANIUM AGENCY, INC. 651-484-4002
JAL TITANIUM AGENCY, INC.
2575 S MARSHALL AVENUE N
ROSEVILLE, MN 55113
James Black

INSURED: JAMES BLACK
JAL No. 651-484-4002 JAL No. 651-484-6185
INSURER: TRAVELERS INSURANCE CO. 19038

COVERAGE: CERTIFICATE NUMBER: 0805K113742 REVISION NUMBER: 01/01/2023

THIS IS TO CERTIFY THAT THE POLICIES OF INSURANCE LISTED BELOW HAVE BEEN ISSUED TO THE INSURED NAMED ABOVE. FOR THE POLICY PERIOD INDICATED, NOTWITHSTANDING ANY REQUIREMENT, TERM OR CONDITION OF ANY POLICY, THE INSURANCE AFFORDED BY THE POLICIES DESCRIBED HEREIN IS SUBJECT TO ALL THE TERMS, EXCLUSIONS AND CONDITIONS OF SUCH POLICIES. LIMITS SHOWN MAY HAVE BEEN EXCEEDED BY THIS CLAIM.

LINE	TYPE OF INSURANCE	DATE	POLICY NUMBER	PERIOD	COVERAGES	LIMITS
A	COMMERCIAL GENERAL LIABILITY	01/01/2023	0805K113742	01/01/2023	ANY OCCURRENCE BODILY INJURY PROPERTY DAMAGE MEDICAL EXPENSES PERSONAL AND ADULTERY GENERAL AGGREGATE PRODUCTS - COMPOUND AGG.	1,000,000 500,000 500,000 1,000,000 2,000,000 2,000,000
X	AUTOMOBILE LIABILITY	01/01/2023	0805K113742	01/01/2023	ANY OCCURRENCE BODILY INJURY PROPERTY DAMAGE MEDICAL EXPENSES PERSONAL AND ADULTERY GENERAL AGGREGATE PRODUCTS - COMPOUND AGG.	1,000,000 500,000 500,000 1,000,000 2,000,000 2,000,000
A	UMBRELLA LIA	01/01/2023	CUPEK113729	01/01/2023	ANY OCCURRENCE BODILY INJURY PROPERTY DAMAGE MEDICAL EXPENSES PERSONAL AND ADULTERY GENERAL AGGREGATE PRODUCTS - COMPOUND AGG.	3,000,000 3,000,000 3,000,000 3,000,000 3,000,000 3,000,000
A	WORKERS' COMPENSATION AND EMPLOYERS' LIABILITY	01/01/2023	UBIT973263	01/01/2023	ANY OCCURRENCE BODILY INJURY PROPERTY DAMAGE MEDICAL EXPENSES PERSONAL AND ADULTERY GENERAL AGGREGATE PRODUCTS - COMPOUND AGG.	1,000,000 1,000,000 1,000,000 1,000,000 1,000,000 1,000,000

DESCRIPTION OF OPERATIONS - LOCATIONS - VEHICLES (ACORD 101, Additional Remarks Schedule, may be attached if more space is required)
Twin Cities Pride is an additional insured with respect to the general liability.

CERTIFICATE HOLDER: Twin Cities Pride
1615 Harmon Place
Minneapolis, MN 55403

CANCELLATION: SHOULD ANY OF THE ABOVE DESCRIBED POLICIES BE CANCELLED BEFORE THE EXPIRATION DATE THEREOF, NOTICE WILL BE DELIVERED IN ACCORDANCE WITH THE POLICY PROVISIONS.

AUTHORIZED REPRESENTATIVE: Mark Mader

ACORD 25 (01/16/03) © 1989-2018 ACORD CORPORATION. All rights reserved.

Letter on Company/State letterhead is acceptable in place of a COI when Self-Insured:



DATE: July 1, 2022 and continuous until cancelled
FROM: State of Minnesota Risk Management Division
TO: To Whom It May Concern

RE: Self-Insurance Letter: General Liability, Auto Liability, and Workers' Compensation

This letter is being provided in lieu of a Certificate of Insurance.

This letter is to certify that the Minnesota Department of Management and Budget is an agency of the State of Minnesota and is self-insured with respect to its General Liability, Auto Liability, and Workers' Compensation coverages as provided by statute.

General Liability

Minnesota Statute 3.732 prescribes the settlement of claims and Minnesota Statute 3.736 Tort Claims prescribes the limits, exclusions and procedures, with the limits being \$500,000 per person and \$1,500,000

Note: Falsifying Insurance Documents is considered Insurance Fraud according to MN Statute 609.611





Packet Pick-up



BOOTH & CANNABIS VENDORS

Pride Cultural Arts Center

1201 Harmon Place, Minneapolis, MN 55403

Our Entrance is located on 12th between Harmon & Yale

FOOD VENDORS

Pride Office

1618 Harmon Place, Minneapolis, MN 55403

Wednesday, Thursday, Friday

June 11th-13th 9:30 AM-7:30 PM

Saturday June 14th 8AM - 1PM

Or on June 25-28 at Vendor Central in Loring Park

- Entry Pass - for vehicle to enter Load-in / Load-out
- Booth Sign – parking and Wi-Fi vouchers – festival information
- Confirm your booth Information
- Review the Routes and Booth Location
- Scope out your spot



2025 Twin Cities Pride Festival



Setup Information

IMPORTANT TIMELINE

NEW THIS YEAR:

- 12 hours is not enough time for all our vendors to get loaded in and exiting in 2 hours is logistically crazy
- 2 week of setup in Loring Park. **June 15-27**

Impact for Vendors

- *Packet Pickup on scheduled days June 11-14 or in Loring Park at Vendor Central June 25-27.*

No Packet Pick-up 15th-24th

- *Thursday Load-in and Monday Load Out*

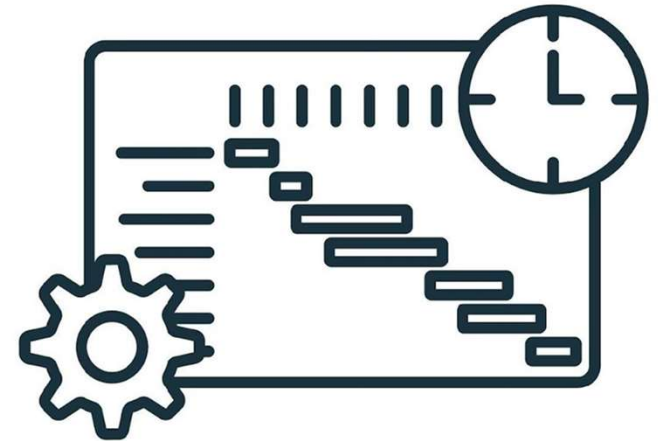

LIVE
PROUD



2025 Twin Cities Pride Festival

Vendor Integrity Team



Why a Vendor Integrity Team?

At the Twin Cities Pride Festival, we believe in continuous improvement and the creation of a vibrant, welcoming space for all. The Vendor Integrity Team is a proactive initiative aimed at ensuring that our vendors contribute to the festival's core values of diversity, inclusivity, and professionalism. Our primary goal is to foster a positive and inclusive environment where vendors, festival-goers, and the community can thrive together.

Responsibilities

- Upholding Festival Policies & Standards
- Addressing Rogue Vendors
- Secret Shopping
- Handling Vendor Complaints
- Nurturing a Positive Community Experience
- Empowering Vendor Success

LIVE
PROUD



2025 Twin Cities Pride Festival

VIT Process & Code of Conduct

[Vendor Code of Conduct](#) - (online & in packets)

Twin Cities Pride has a zero-tolerance policy when it comes to disrespecting our venue staff, contractors, sponsors, volunteers, attendees, or other vendors.

CoC includes the following sections:

- Respect for Human Rights, Diversity, and Inclusion
- Acting with Integrity and Transparency
- Health, Safety, and Inclusive Environment
- Commitment to Education, Awareness and Continuous Improvement
- Collaboration and Community Engagement
- Environmental Responsibility
- Consequences of Unacceptable Behavior



Process:

- Report / Concern
- VIT Team discuss with people involved
- Resolve – Warning – Removal

Contact Dispatch with requests / concerns

Phone or Text: (612) 255-3265

Applies to all people who staff a booth or represent your organization at the festival.

**LIVE
PROUD**



2025 Twin Cities Pride Festival

Safety Briefing

Road Closures & Controlled Access

- **Willow Street**
 - CLOSED - (Grant to Yale) Wednesday, June 25
 - PERMIT ONLY- (Grant to 15th) Friday, June 27
- **Yale Place**
 - PERMIT ONLY - (Willow to Spruce) Friday, June 27
- **Grant Street**
 - PERMIT ONLY- (Willow to Spruce) Friday, June 27
- **14th Street**
 - PERMIT ONLY - (Willow to Spruce) Friday, June 27
- **Harmon Place**
 - CLOSED - (Maple to Hennepin/Lyndale) Saturday, June 28



LIVE
PROUD



2025 Twin Cities Pride Festival

Safety Briefing

Safety Protocols – OUR PART

The Twin Cities Pride Health and Safety team coordinates a comprehensive all-hazards Safety Plan with our security team, medical services, local law enforcement, traffic control agents, and emergency management throughout the Festival space, Rainbow Run and Parade route.





2025 Twin Cities Pride Festival

Safety Briefing

Safety Protocols – YOUR PART

- **Be Kind and Helpful**
- **Report**
 - Violence, threats, or hate.
 - Unattended bags, suspicious activity.
 - Drones.
- **Attendance**
 - Don't attend/travel alone.
 - Write down emergency contacts & let them know.
 - Meet-up spot.
- **Self-Care**
 - Stay hydrated!
 - Wear sunscreen, find shade, and take breaks from the sun.
 - Wear comfortable closed-toe shoes.
 - Know your limits.



Note: Air-conditioning tents are available at family services, the escape space or any of the medical tents.
Free Water is also provided at each food court.

LIVE
PROUD

Sign up now for Festival Text Alerts



Text the following “keywords” to 333111

- **TCPRIDE** - Public Messaging Alerts.
(opt-in expires 7/7/25)
- **TCPVENDOR** - Festival Vendor Messaging / Alerts
(opt-in expires 7/7/25)



2025 Twin Cities Pride Festival

Festival Map

<https://tcpride.org/festival-map/>

- FIND YOUR BOOTH NUMBER WITH INTERACTIVE MAP
- Most Current Map and Information
- PDF Version
- Interactive MAP with links to vendors
- Accessibility Map
- List of Vendors (closer to festival)

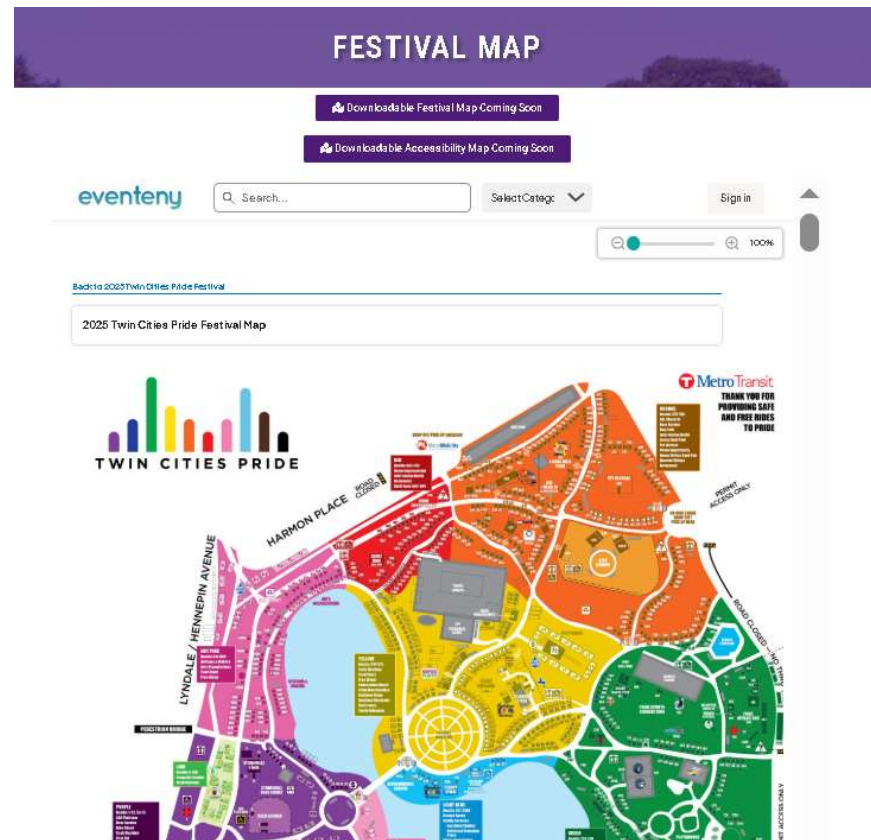

LIVE
PROUD



2025 Twin Cities Pride Festival

Color Sections

Section Color	Section Description
Hot Pink	Artisans, Art Organizations, Food Court & Trucks
Purple	Religious & Political Organizations, Stonewall Stage, Food Court & Trucks, Beer Garden, Bike Check, ADA Platform, First Aid
Lime Green	THC / Cannabis Garden
Pink	LGBTQ Artist, Art Installation, Artist Alley (Artists In Residence)
Blue	Community Organizations, Businesses, Community Tent, Our Space, P2P Stage, ADA Platform, Food Court & Trucks
Green	Businesses, Pride Organizations, Pride Sports Organizations, Sober Pride, Volunteer Check-in, Vendor Central, First Aid, HIV Testing, History Pavilion, NSGRA Dance Tent
Light Blue	Escape Space, Family Services & Rainbow Wardrobe, Universal Changing Place & Remembrance Garden
Yellow	Youth Hide Away, Rainbow Wardrobe – Gender Affirming Clothes, Businesses, Schools, Rainbow Stage, Pride Merchandise, Food Court & Trucks
Orange	Pet Zones, Dog Park, Living Well Park, Beer Garden, Queer Writers, Quorum Village, ASL, Schools and Businesses, Small Business Tent
Red	Home Improvement Zone, Mature Audiences (Adult) Zone, Businesses



2025 Twin Cities Pride Festival

Locations

- D** Dumpster
- G** Grease
- GW** Grey Water
- I** Ice
- R** Recycling
- W** Water
- ★ Office
- VC** Vendor/
Volunteer
Central

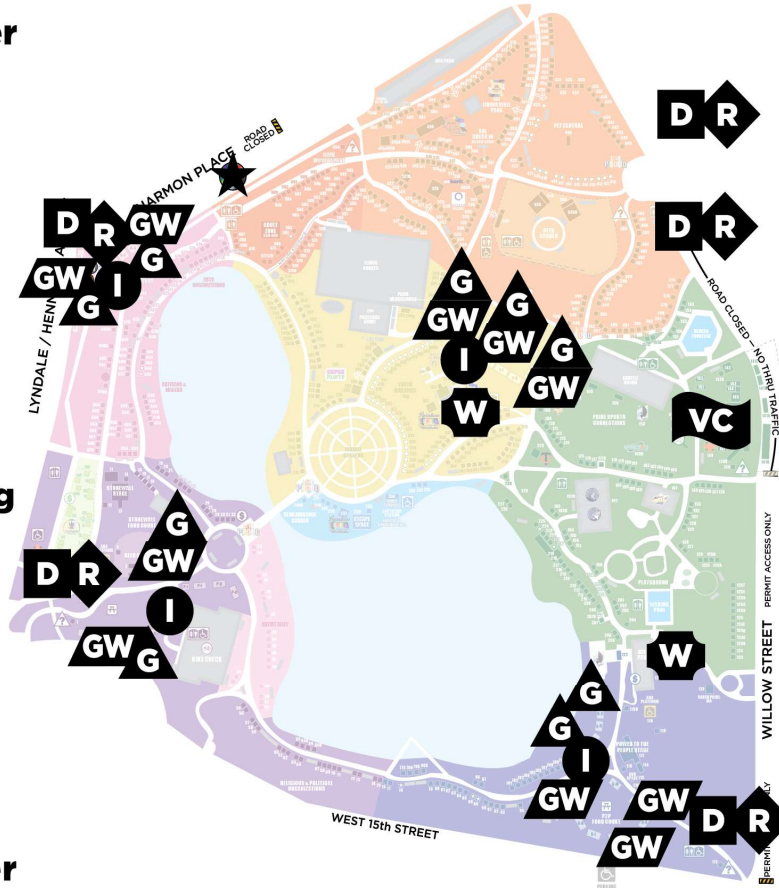



2025 Twin Cities Pride Festival

Setup Information

Confirm Booth Location before Setup

- **Confirm your spot - Location is Marked on Ground**
 - Attach booth # to booth (zip ties provided)
 - **Wrong tent location – you will be asked to move**

This is the LINE – FRONT OF BOOTHS

“L” Bracket indicates FRONT of booth

Not the Sidewalk



Example Booth Location





2025 Twin Cities Pride Festival

Setup Information

Tent & Vehicles

- **TENTS MUST BE WEIGHTED OR STAKED**

- 40lbs per tent leg 10x10 - Sand, water, weights
- **Paint on Ground indicates:**
 - **RED POWER**
 - **BLUE WATER**
 - **YELLOW GAS**
 - **ORANGE COMMUNICATION** – Anything but WHITE ASK.



- **SATURDAY OR SUNDAY NO VEHICLES ALLOWED IN THE PARK for Load-In or Restocking**

LIVE
PROUD



2025 Twin Cities Pride Festival

Setup Information

Trash Management

- Haul your trash to **DUMPSTERS**
- Flatten cardboard
- DO NOT fill cardboard boxes with trash.
- Watch weight in bags DO NOT OVERLOAD - humans are hauling.
- No Grease disposal **in garbage OR GRAY WATER**
- Gray Water & Grease disposal signs on special barrels.



LIVE
PROUD



2025 Twin Cities Pride Festival

Setup Information

Vendor Bathrooms

Bathrooms Labeled Vendor Bathroom

“Please Give Vendors Priority!”

Please allow them to step to the front of the line so they can get back to making this a great festival for us all.”



LIVE
PROUD



2025 Twin Cities Pride Festival

Setup Information

Festival Parking

<https://tcpride.org/transportation-parking/>

- **Parking Area on Route Maps are for LOAD-IN ONLY**
 - No PARKING in LORING PARK!!!
 - **FREE METRO TRANSIT Passes**
 - **1-day or 3-day parking (7-15 min walk) available for a cost (\$20/\$50).**
 - **Dunwoody Parking for Vendors & Volunteers.**
 - Parking Garages and Surface Lots available downtown/uptown.
- Load-in:** You have a 2 hour time window to enter, unload and setup. Move vehicles asap and within the 2 hour window for next wave of vendors.

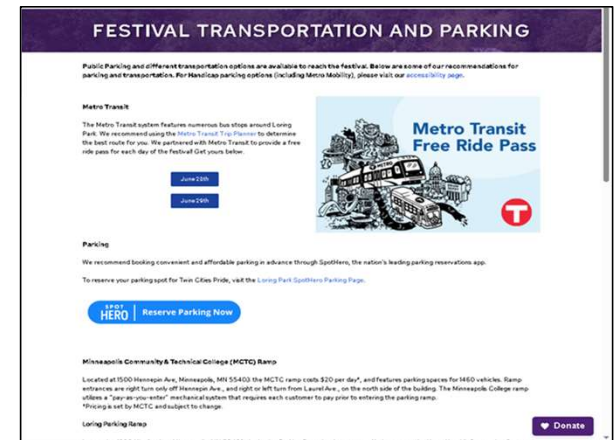

LIVE
PROUD



Cost per car:

\$20 per day

\$50 3-day pass (thur/fri-sat-sun)

Location:

Dunwoody College

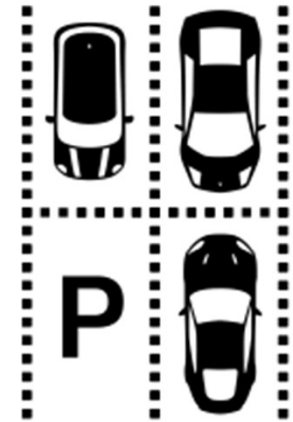
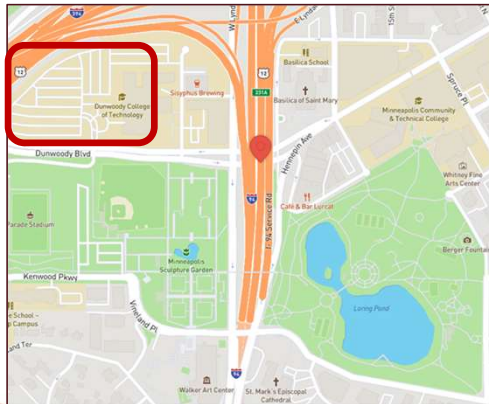

1-day or 3-day parking (7-15 min walk)

After June 1st - available onsite

<https://www.eventeny.com/events/vendor/?id=30114>

Also available are city and private parking garages and surface lots in downtown/uptown.

LIVE
PROUD



Wi-Fi Access



Cost per device:

- ~~\$175 until May 1st~~
- \$225 until June 1st
- \$275 onsite (for the weekend)
- \$30 onsite (for 1 hour)



After June 1st - available onsite

<https://www.eventeny.com/events/vendor/?id=30114>

<https://tcpri.de/wifi>

Temporary Wi-Fi network in Loring Park.

LIVE
PROUD



ICE



Pre-Purchase 18lbs ICE for \$9 per bag

- Pickup Ice at 1 of 4 Ice Booth Locations



After June 1st - available onsite

<https://www.eventeny.com/events/vendor/?id=30114>

During the festival the cost will be \$11.35 Credit / \$11 Cash

**No Refunds for
any unused Ice**

**LIVE
PROUD**



Packet Pick-up



BOOTH & CANNABIS VENDORS

Pride Cultural Arts Center

1201 Harmon Place, Minneapolis, MN 55403

Our Entrance is located on 12th between Harmon & Yale

FOOD VENDORS

Pride Office

1618 Harmon Place, Minneapolis, MN 55403

Wednesday, Thursday, Friday

June 11th-13th 9:30 AM-7:30 PM

Saturday June 14th 8AM - 1PM

Or on June 25-28 at Vendor Central in Loring Park

- Entry Pass - for vehicle to enter Load-in / Load-out
- Booth Sign – parking and Wi-Fi vouchers – festival information
- Confirm your booth Information
- Review the Routes and Booth Location
- Scope out your spot



2025 Twin Cities Pride Festival

Packet Pickup Locations

FOOD VENDORS

Pride Office

1618 Harmon Place,
Minneapolis, MN 55403

Food Vendor
Packet Pickup

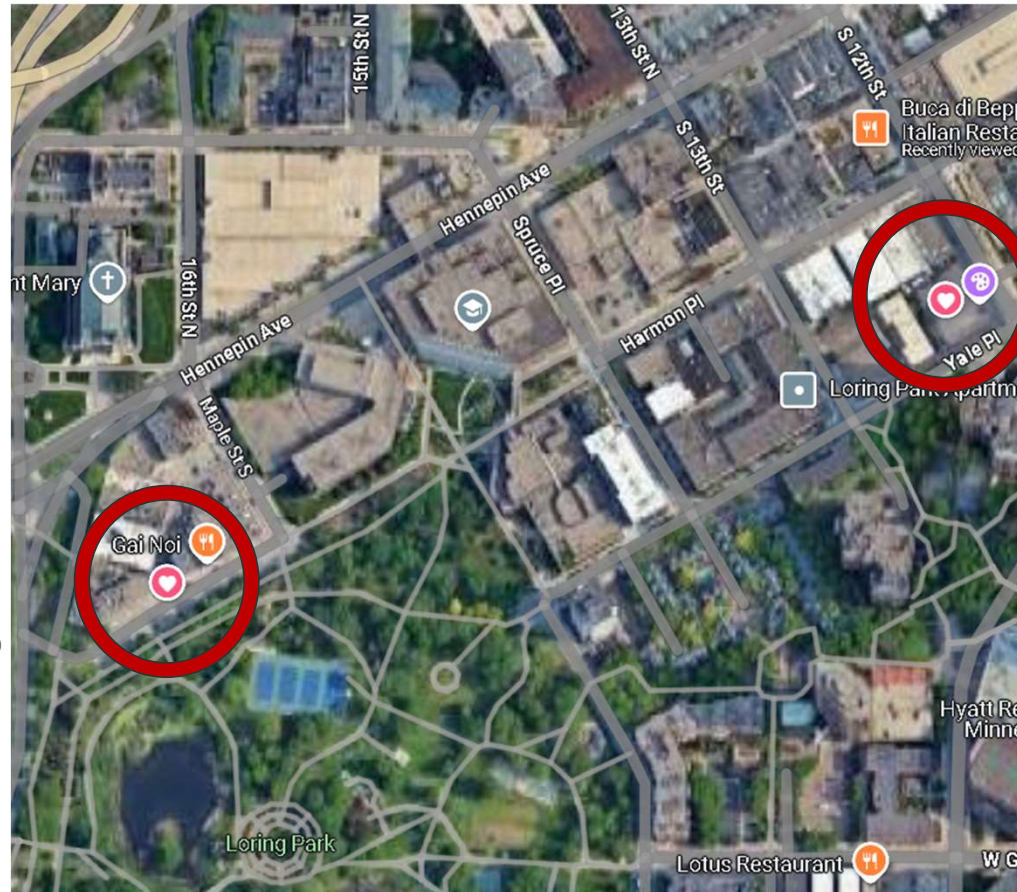

Booth & Cannabis
Vendors Packet Pickup

BOOTH & CANNABIS
VENDORS

Pride Cultural Arts Center

1201 Harmon Place,
Minneapolis, MN 55403

Our Entrance is located on 12th
between Harmon & Yale





2025 Twin Cities Pride Festival



Load-In / Set-up

June 26 & 27, 2024 in Loring Park

26th - Thursday Time Slots

- Morning Food Vendors (19)
- Morning Booth Vendors (24)
- Afternoon Food Vendors (12)
- Afternoon Booth Vendors (47)

27th - Friday Time Slots

- 7-9 AM Food Vendors (3)
- 9-11 AM Booth Vendors (137)
- 11-1 PM Booth Vendors (116)
- 1-3 PM Booth Vendors (138)

All vendor set up ends & exit park by 3 PM Friday



1 Vehicle allowed - MUST HAVE Entry Pass

NOTE: Also needed for Load Out – Store in Booth

Sample Entry Pass & Route Queue





2025 Twin Cities Pride Festival



What Route to get to my Booth?

ROUTE 1

Purple: 01 – 32
Food ALL PA - PR
Pink: 33 - 34
Lime Green: ALL 5-10D
Yellow: 245B - 264
Red: ALL 562 – 610

ROUTE 2

Pink: 35 - 54
Purple: 55-75
Blue: ALL 76 - 122
Food ALL BA - BM
Green: 123 – 152, 158-161,
175 - 230

ROUTE 3A

Green: 153 – 157C, 162-174
Lt Blue: ALL 231 - 240
Yellow: 241-245, 265 – 375
Food ALL YA - YL
Rose: ALL 376-396
Orange: 397 - 409, 522 – 561

ROUTE 3B

Orange: 410 - 521B

ROUTE 4

Hot Pink: Food ALL HA - HJ
Food Storage FS1-FS4





2025 Twin Cities Pride Festival



What Route to get to my Booth?

Route Maps pdf's

- Entry & Queue
- Park Load-in/Out

this deck, route maps, and
recordings of sessions

available at:

<https://tcpride.org/2025vendorinfo/>

The screenshot shows the '2025 Vendor Info' website. The main heading is 'VENDOR INFO'. On the left is a sidebar with links: REGISTRATION INCLUDES, LOAD-IN / LOAD-OUT, PACKET PICKUP INFORMATION, SPACE / SIZE, PROMOTION / SOCIAL MEDIA, BOOTH SHARING, FESTIVAL COLOR SECTIONS & PROGRAMMING AREAS, PRICING & PAYMENT, Power/Electrical, Insurance, and Who Should Apply. The main content area is titled 'WHICH ROUTE TO GET TO MY BOOTH?'. It lists five routes with their respective color-coded boxes and details:

- ROUTE 1** (Purple): Purple: 01-02, Food: ALL; Pink: 33-34; Light Green: ALL; Yellow: 245B-264; Hot Pink: ALL; Red: ALL.
- ROUTE 2** (Blue): Pink: 35-54; Purple: 55-75; Blue: ALL, Food: ALL; Green: 123-152, 158-161, 175-238.
- ROUTE 3A** (Red): Green: 103-107C, 167-174; All Blue: ALL; Yellow: 245-249, 265-375; Food: ALL; Orange: 278-408, 522-561.
- ROUTE 3B** (Orange): Orange: 410-528B.
- ROUTE 4** (Brown): Hot Pink: Food: ALL; Food Storage: ALL.

Below the routes, there is a list of links for each route: Route 1 - Entry and Queue | Park Load-In/Out; Route 2 - Entry and Queue | Park Load-In/Out; Route 3A - Entry and Queue | Park Load-In/Out; Route 3B - Entry and Queue | Park Load-In/Out; Route 4 - Entry and Queue. At the bottom, there is a 'Frequently Asked Questions' section and a 'Donate' button.



2025 Twin Cities Pride Festival



MAP LEGEND & Instructions

Red Loop – CARS ONLY

NO VEHICLES ALLOWED

Load-in is WALK IN ONLY

ONE-WAY TRAVEL



Parking Area

LOAD IN ONLY

NO FESTIVAL PARKING

**Two way travel only in part of
Route 2**



Cars Only – NO TRUCKS OR TRAILERS.



No Vehicle Travel beyond this point.



Load-In is Walk/Cart in Only – NO Cars in these areas. Park in the correct parking area for your booth number.



Direction of travel is ONE WAY in the park shown by the double arrow.

- Vehicles only allowed along black arrow path or in parking areas.
- Do Not block paths when parking to unload.
- Load-In window is 2 hours please arrive, unload and exit the park in that time. You can walk back in and spend as much time as needed setting up your booth.



Direction of travel is TWO WAY in the park shown by the four arrows.

**LIVE
PROUD**

ROUTE 1

Purple: 01 – 32
Food ALL PA - PR
Pink: 33 - 34
Lime Green: ALL 5-10D
Yellow: 245B - 264
Red: ALL 562 – 610

Route Entry & Queue Map

Directions to get into line (queue) to minimize traffic congestion.

ROUTE 1A + 1B ENTRY AND QUEUE

Take Lasalle Ave to Oak Grove Street, head westbound, go to West 15th Street, turn left onto Oak Grove Street/West 15th and line up in the metered spaces to enter Loring Park on the right with Entry Pass before you get to Hennepin. Venders enter at 1 and then split into Booth & Cannabis Vendors at 1A and Food Vendors at 1B.

DO NOT attempt to enter Loring park by turning off of Hennepin Avenue onto Oak Grove and cutting in front of traffic to turn into the Park.

Please follow these directions!

Maps available at <https://tcpride.org/2025vendorinfo/>

ROUTE 1 LOAD-IN/LOAD-OUT

Purple: 01-32, Food: ALL
Pink: 33-34
Lime Green: ALL
Yellow: 245B-264
Hot Pink: ALL
Red: ALL

ENTRY AND QUEUE

Entry Pass required to enter park. Take Lasalle Ave to Oak Grove Street, head westbound, go to West 15th Street, turn left onto Oak Grove Street/West 15th and line up in the metered spaces to enter Loring Park on the right with Entry Pass before you get to Hennepin. Venders enter at 1 and then split into Booth & Cannabis Vendors at 1A and Food Vendors at 1B. DO NOT attempt to enter Loring park by turning off of Hennepin Avenue onto Oak Grove and cutting in front of traffic to turn into the Park.

→ Route 1 Queue
— Road Closed
— Controlled Entry

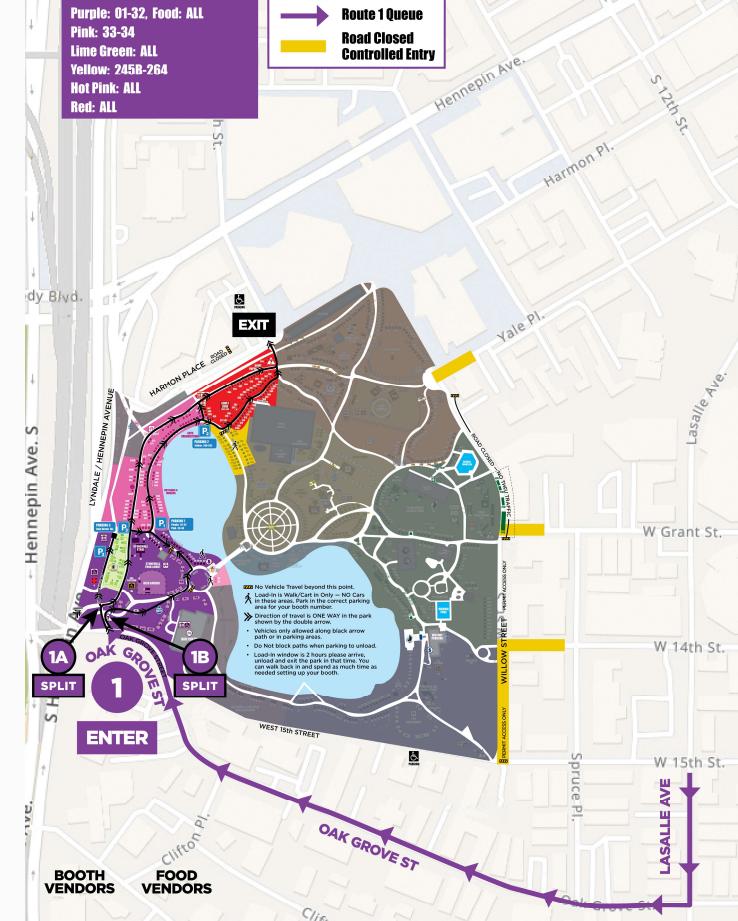

LOAD-OUT

ENTRY PASS REQUIRED TO ENTER PARK FOR LOAD-OUT. Load-Out Sunday 7-8 PM: Small commercial vehicles are allowed in the park for Load-Out. At 8 PM, entry into the park will stop until Food Trucks have exited under escort at the entry point. All other vehicles should exit according to the flow of traffic indicated by black line and double arrows. Vehicle entry will resume sometime around 9 PM or when Food Trucks have exited.

ROUTE 1

Purple: 01 – 32

Food ALL PA - PR

Pink: 33 - 34

Lime Green: ALL 5-10D

Yellow: 245B - 264

Red: ALL 562 – 610

Load-In Thursday June 26 & Friday 27th

- Food Vendors (Thursday 26th)
- Booth Vendors (Thurs/Fri 26 & 27) in 2 hour shifts
- Picked a 2 hour window to arrive

Instructions for Load-Out:

- Festival Ends 6 PM
- Cars in at 7 PM
- Large Trucks in at 8 PM
- Food Truck Exit at 8 PM

Maps available at <https://tcpride.org/2025vendorinfo/>

Route Load-in/Out Map

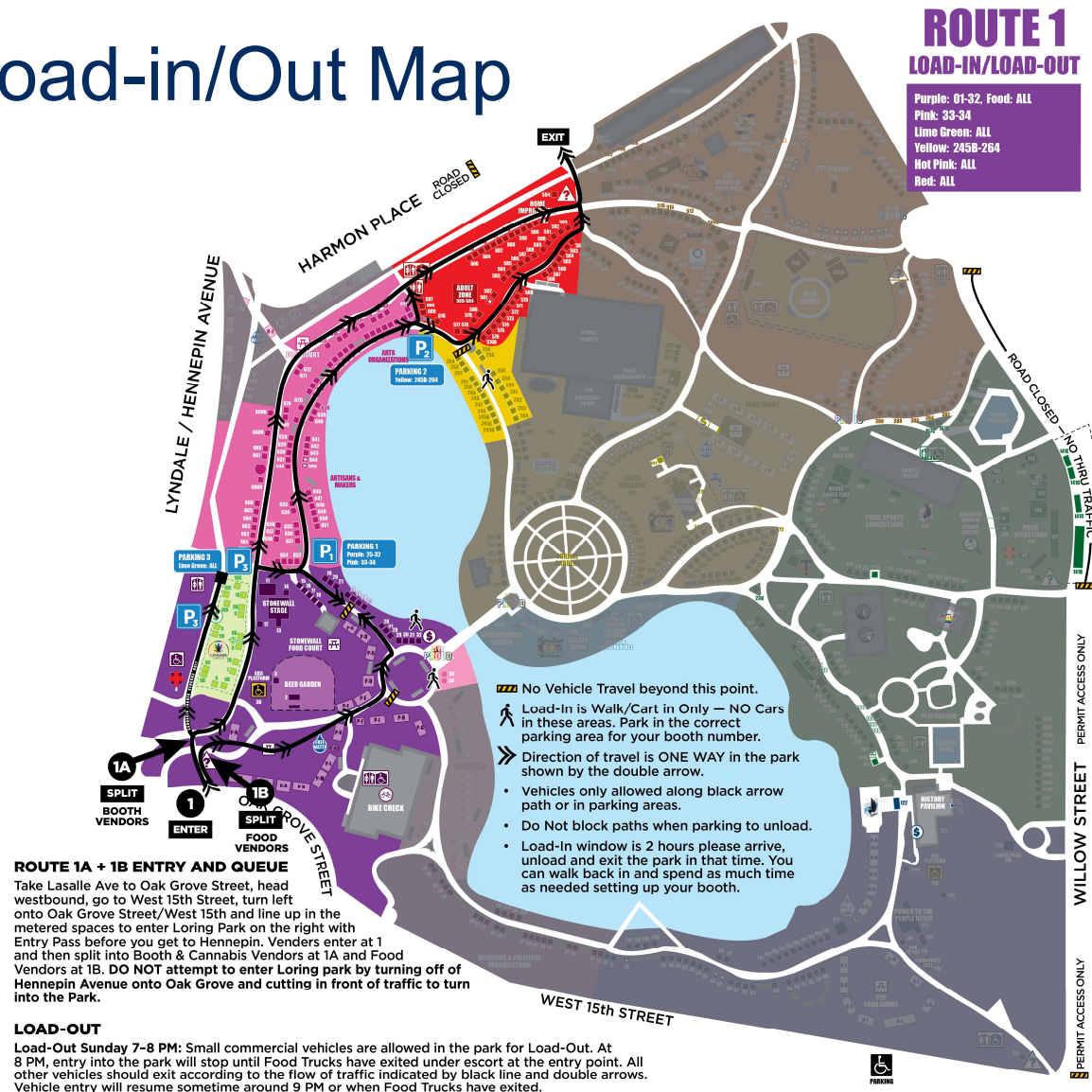

ROUTE 1

Purple: 01 – 32

Food ALL PA - PR

Pink: 33 - 34



Lime Green: ALL 5-10D

Yellow: 245B - 264

Red: ALL 562 – 610

NOTE:

- 1 entrance split into 1A Booth Vendors
- 1A Cannabis Vendors (parking P3 Lime Green)
- 1B - Food Vendors – follow route not sidewalk
(tight turn don't jump curbs)
- Parking Purple 25-32, Pink 33-34 & Yellow 245B-264
- Walking Icons
- Direction of Travel
- No Vehicle beyond this point

 No Vehicle Travel beyond this point.
 Load-In is Walk/Cart in Only – NO Cars in these areas. Park in the correct parking area for your booth number.
 Direction of travel is ONE WAY in the park shown by the double arrow.
 • Vehicles only allowed along black arrow path or in parking areas.
 • Do Not block paths when parking to unload.
 • Load-In window is 2 hours please arrive, unload and exit the park in that time. You can walk back in and spend as much time as needed setting up your booth.



ROUTE 2

Pink: 35 - 54
 Purple: 55-75
 Blue: ALL 76 - 122
 Food ALL BA - BM
 Green: 123 – 152, 158-161,
 175 - 230

Route Entry & Queue Map

Directions to get into line (queue) to minimize traffic congestion.

ROUTE 2 ENTRY AND QUEUE

Take LaSalle Ave to West 14th Street, head westbound toward the Park, enter Controlled Entry for local traffic with Entry Pass, turn left onto Willow go up toward West 15th Street, turn right into Loring Park with Entry Pass before you get to West 15th Street.

DO NOT attempt to enter into Loring Park from West 15th Street.

EXIT AT GRANT AND WILLOW

When exiting the Park at Grant and Willow, proceed forward on West Grant Street until you get to LaSalle Ave to avoid other route queues lining up to get into the park. DO NOT turn onto Willow Street, this road is closed.

Please follow these directions!

Maps available at <https://tcpride.org/2025vendorinfo/>

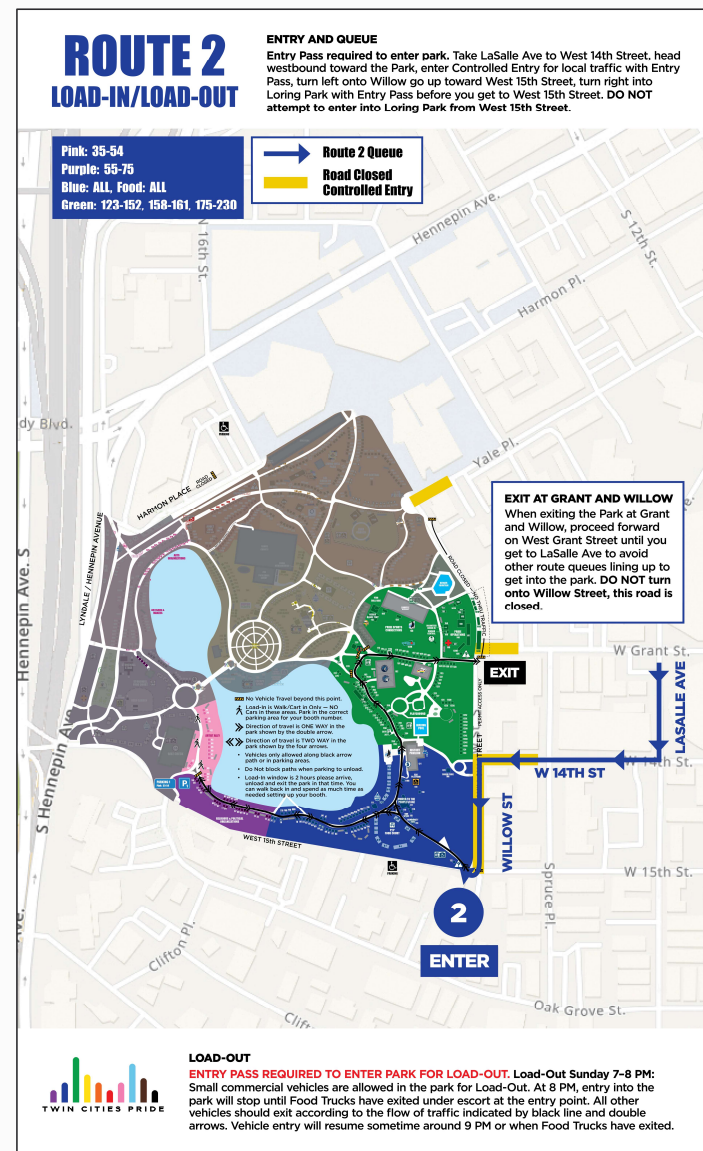

ROUTE 2

Pink: 35 - 54

Purple: 55-75

Blue: ALL 76 - 122

Food ALL BA - BM

**Green: 123 – 152, 158-161,
175 - 230**

Route Load-in/Out Map

Load-In Thursday June 26 & Friday 27th

- **Food Vendors (Thursday 26th)**
- **Booth Vendors (Thurs/Fri 26 & 27)**
in 2 hour shifts
- **Picked a 2 hour window to arrive**

Instructions for Load-Out:

- **Festival Ends 6 PM**
- **Cars in at 7 PM**
- **Large Trucks in at 8 PM**
- **Food Trucks Exit at 8 PM**

Maps available at <https://tcpride.org/2025vendorinfo/>

ROUTE 2

Pink: 35-54
Purple: 55-75
Blue: All, Food: All
Green: 123-152, 158-161, 175-230

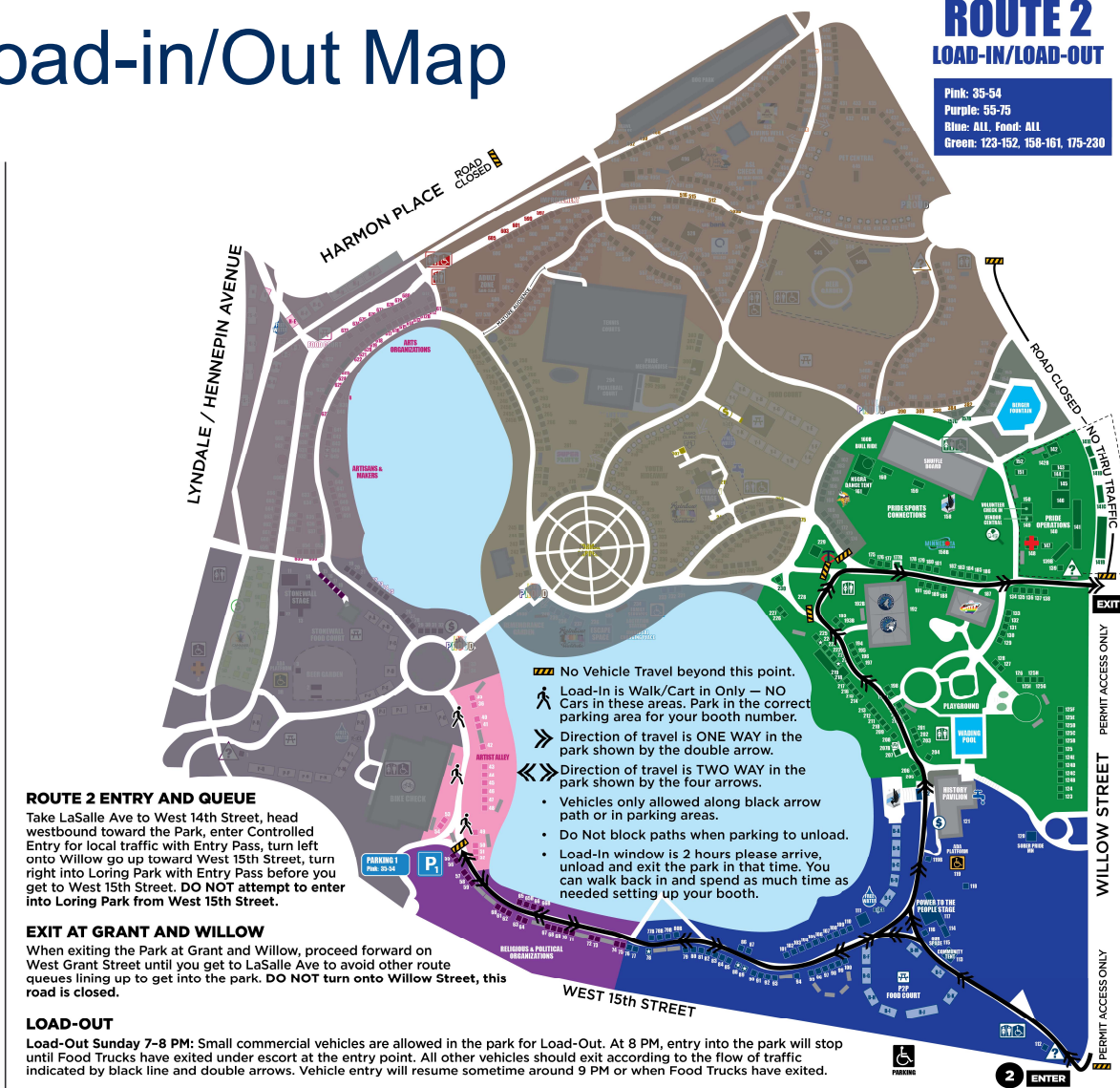

ROUTE 2

Pink: 35 - 54

Purple: 55-75

Blue: ALL 76 - 122

Food ALL BA - BM

**Green: 123 – 152, 158-161,
175 - 230**

NOTE:

- **Parking 35-54**
- **Walking Icons**
- **Direction of Travel**
- **<<--> Two Way Traffic**
- **No Vehicle beyond this point**

 No Vehicle Travel beyond this point.

 Load-In is Walk/Cart in Only — NO Cars in these areas. Park in the correct parking area for your booth number.

➤ Direction of travel is ONE WAY in the park shown by the double arrow.

Direction of travel is TWO WAY in the park shown by the four arrows.

- Vehicles only allowed along black arrow path or in parking areas.

- Do Not block paths when parking to unload.
- Load-In window is 2 hours please arrive, unload and exit the park in that time. You can walk back in and spend as much time as needed setting up your booth.

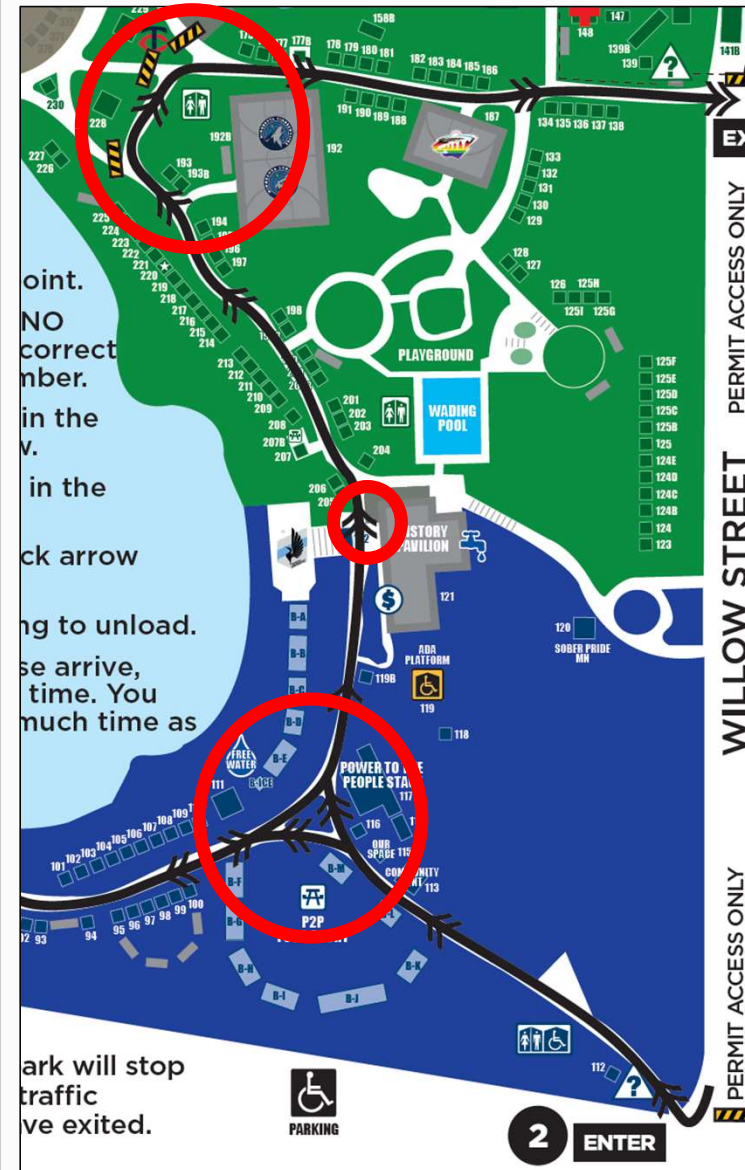
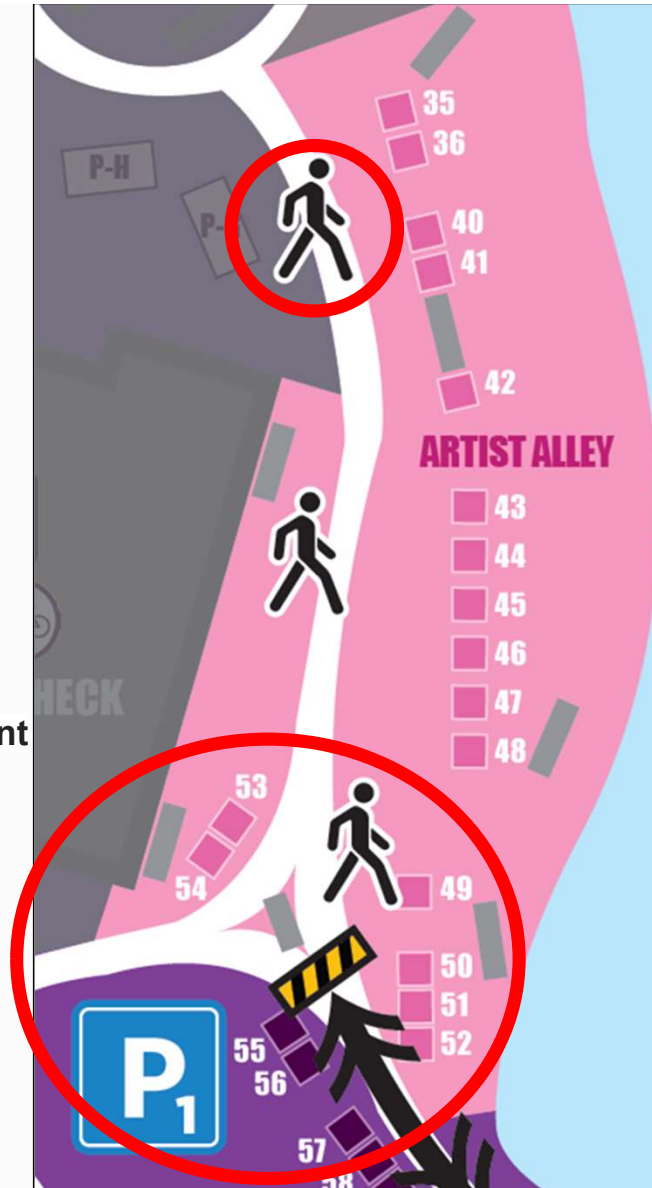

ROUTE 3A

Green: 153 – 157C, 162-174

Lt Blue: ALL 231 - 240

Yellow: 241-245, 265 – 375

Food ALL YA - YL

Rose: ALL 376-396

Orange: 397 - 409, 522 - 561

Route Entry & Queue Map

Directions to get into line (queue) to minimize traffic congestion.

ROUTE 3A ENTRY AND QUEUE

Take Hennepin Ave to South 12th Street, take South 12th Street to Yale, turn right onto Yale heading westbound toward the Park. Follow Yale to Spruce and enter Controlled Entry for local traffic with Entry Pass, proceed forward to split into lanes 3 lanes (3A on Left side of Yale and 3B on Right side of Yale — leaving center lane open/free for local traffic to enter). Proceed forward to enter the Park at 3A with Entry Pass.

EXIT AT GRANT AND WILLOW

When exiting the Park at Grant and Willow, proceed forward on West Grant Street until you get to LaSalle Ave to avoid other route queues lining up to get into the park. DO NOT turn onto Willow Street, this road is closed.

Please follow these directions!

Maps available at <https://tcpride.org/2025vendorinfo/>

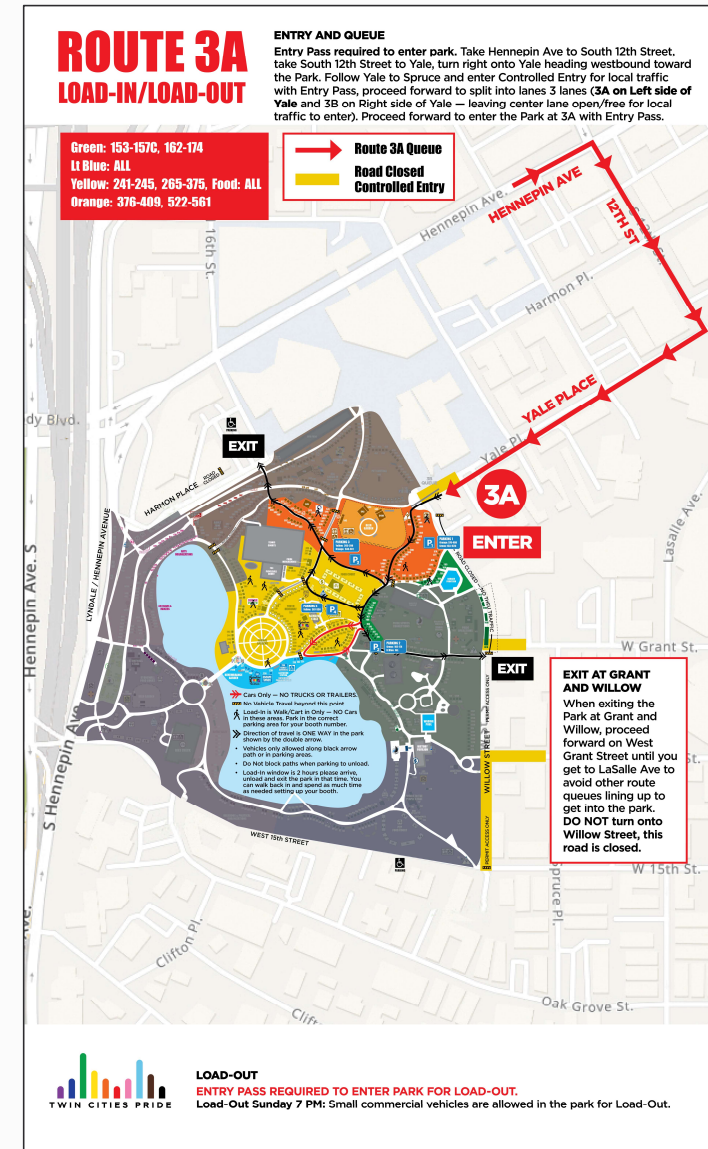

ROUTE 3A

Green: 153 – 157C, 162-174

Lt Blue: ALL 231 - 240

Yellow: 241-245, 265 – 375

Food ALL YA - YL

Rose: ALL 376-396

Orange: 397 - 409, 522 - 561

Load-In Thursday June 26 & Friday 27th

- Food Vendors (Thursday 26th)
- Booth Vendors (Thurs/Fri 26 & 27) in 2 hour shifts
- Picked a 2 hour window to arrive

Instructions for Load-Out:

- Festival Ends 6 PM
- Cars in at 7 PM
- Large Trucks in at 8 PM

Maps available at <https://tcpride.org/2025vendorinfo/>

Route Load-in/Out Map

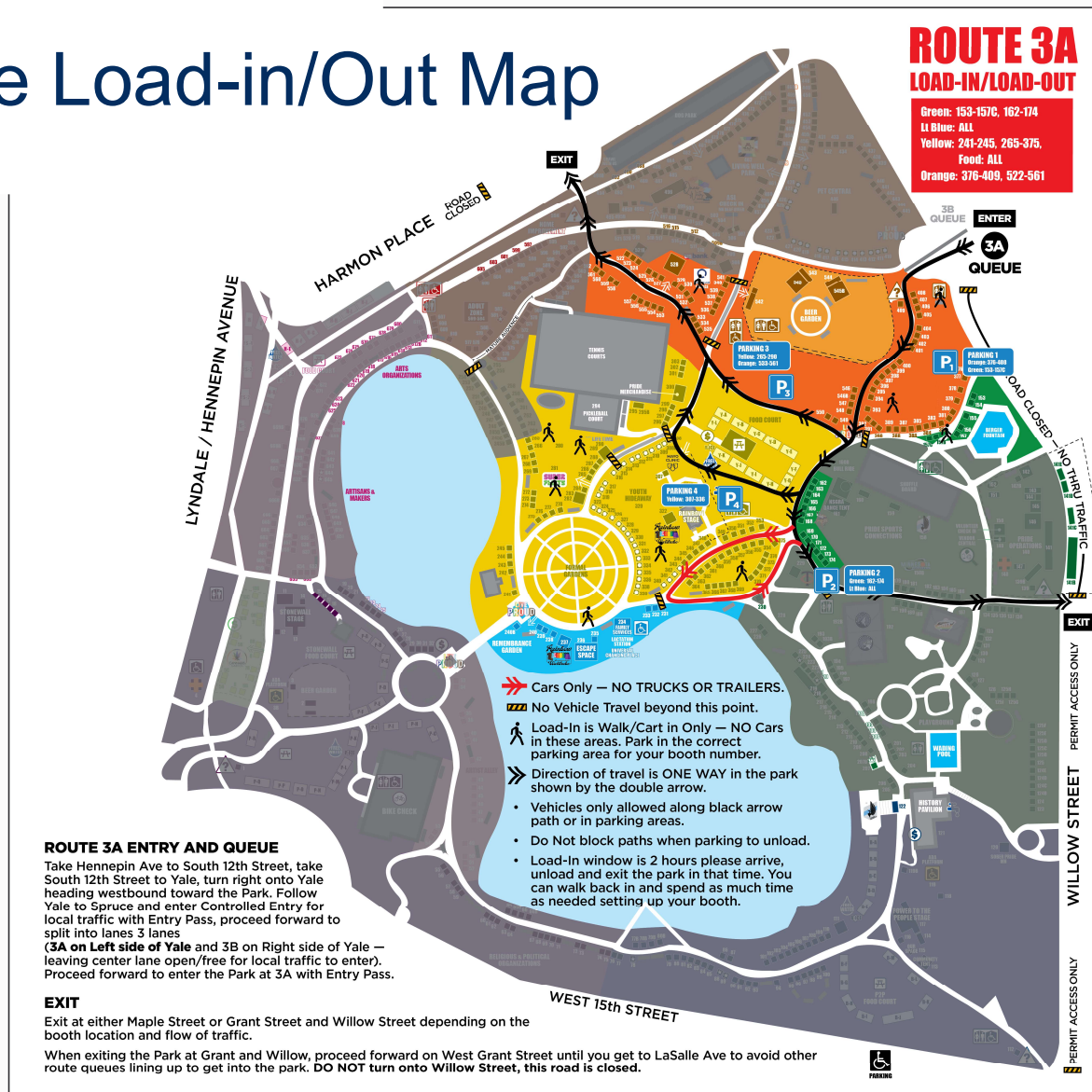

ROUTE 3A

Green: 153 – 157C, 162-174

Lt Blue: ALL 231 - 240

Yellow: 241-245, 265 – 375

Food ALL YA - YL

Rose: ALL 376-396

Orange: 397 - 409, 522 - 561

NOTE:

- Unloading Parking Areas 1- 4
- Walking Icons
- Direction of Travel
- **Car Only Path** – No Trucks
- No Vehicle beyond this point

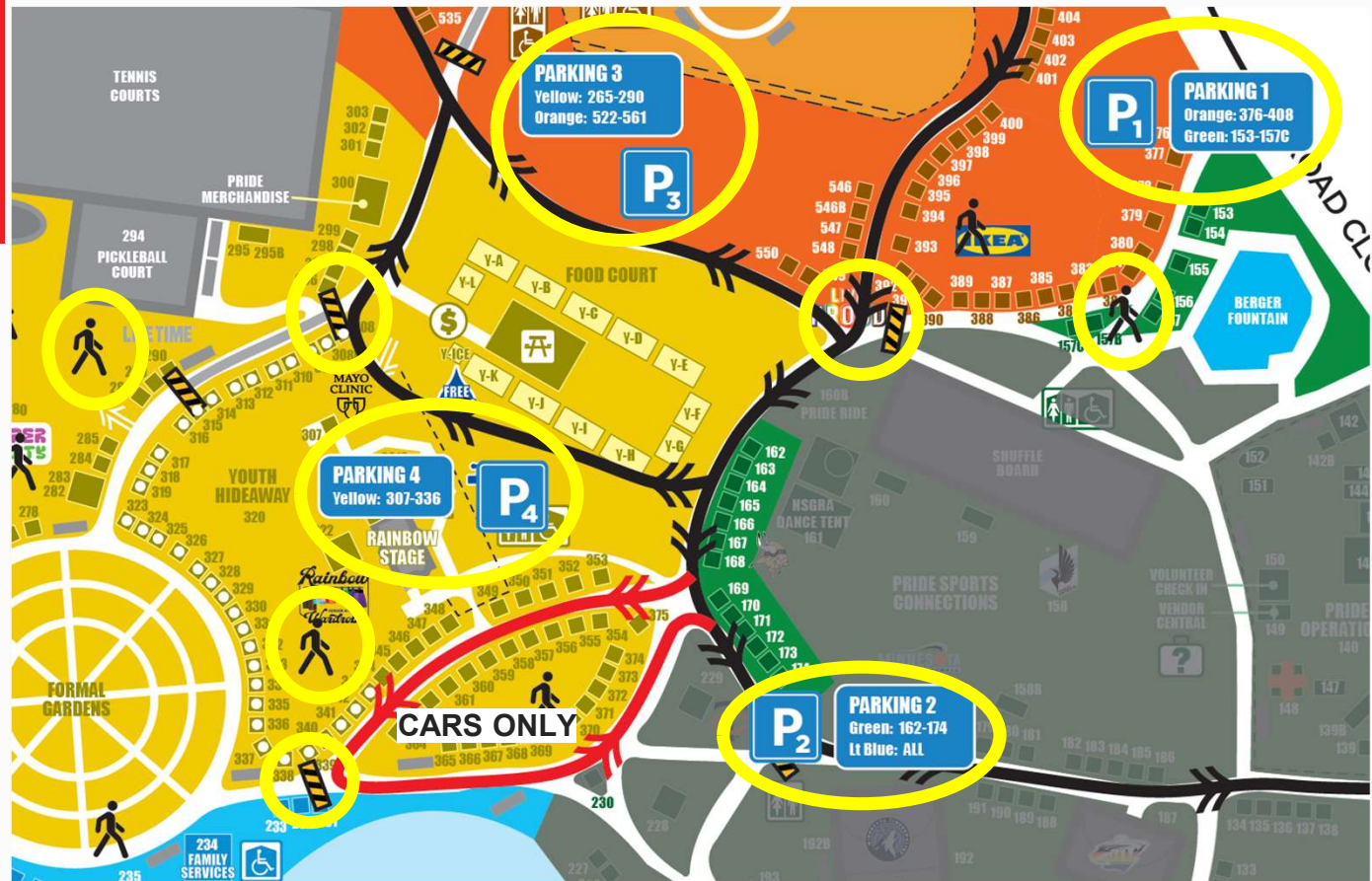
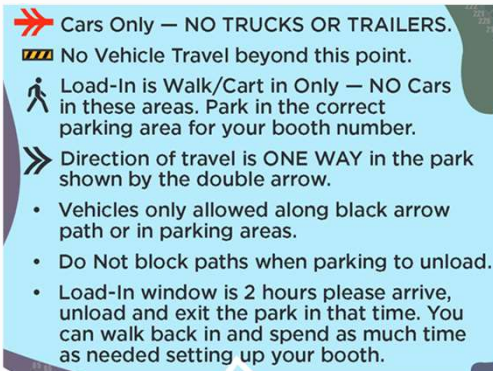

ROUTE 3B

Orange: 410 - 521B

Route Entry & Queue Map

Directions to get into line (queue) to minimize traffic congestion.

ROUTE 3B ENTRY AND QUEUE

Take Hennepin Ave to South 12th Street, take South 12th Street to Yale, turn right onto Yale heading westbound toward the Park. Follow Yale to Spruce and enter Controlled Entry for local traffic with Entry Pass, proceed forward to split into lanes 3 lanes (3A on Left side of Yale and 3B on Right side of Yale — leaving center lane open/free for local traffic to enter). Proceed forward to enter the Park at 3B with Entry Pass.

Please follow these directions!

Maps available at <https://tcpride.org/2025vendorinfo/>

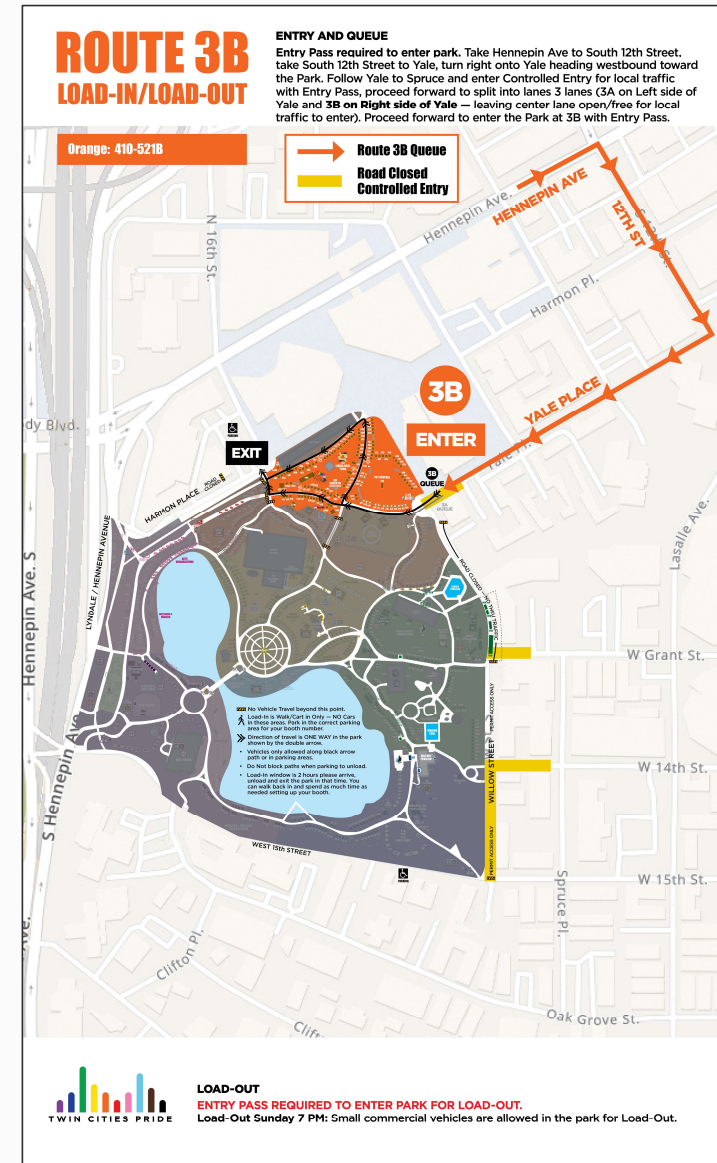

ROUTE 3B

Orange: 410 - 521B

Load-In Thursday June 26 & Friday 27th

- Food Vendors (Thursday 26th)
- Booth Vendors (Thurs/Fri 26 & 27) in 2 hour shifts
- Picked a 2 hour window to arrive

Instructions for Load-Out:

- Festival Ends 6 PM
- Cars in at 7 PM
- Large Trucks in at 8 PM

Maps available at <https://tcpride.org/2025vendorinfo/>

Route Load-in/Out Map

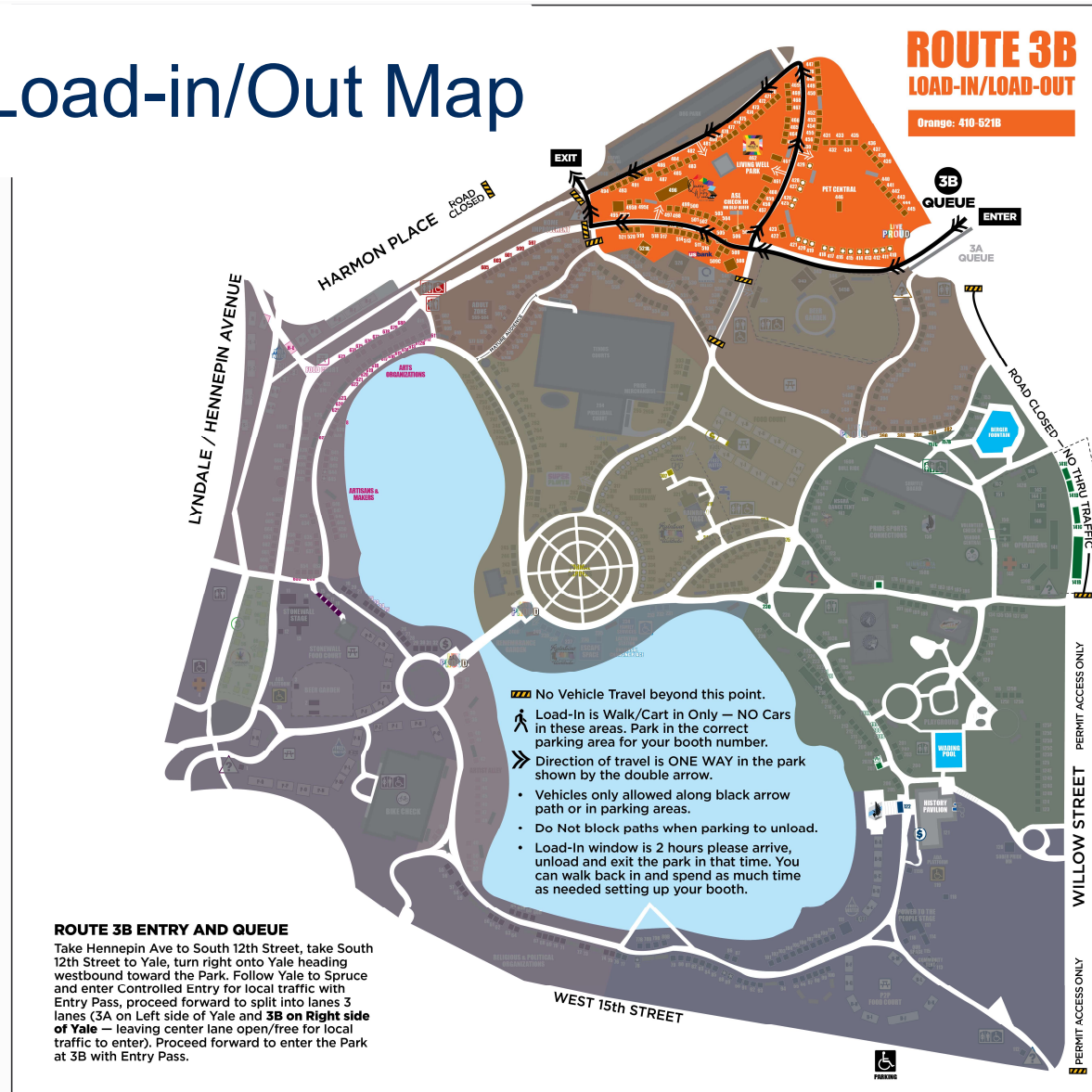



ROUTE 3B

Orange: 410 - 521B

NOTE:

- Direction of Travel
- No Vehicle beyond this point

 No Vehicle Travel beyond this point.

 Load-In is Walk/Cart in Only — NO Cars in these areas. Park in the correct parking area for your booth number.

 Direction of travel is ONE WAY in the park shown by the double arrow.

- Vehicles only allowed along black arrow path or in parking areas.
- Do Not block paths when parking to unload.
- Load-In window is 2 hours please arrive, unload and exit the park in that time. You can walk back in and spend as much time as needed setting up your booth.

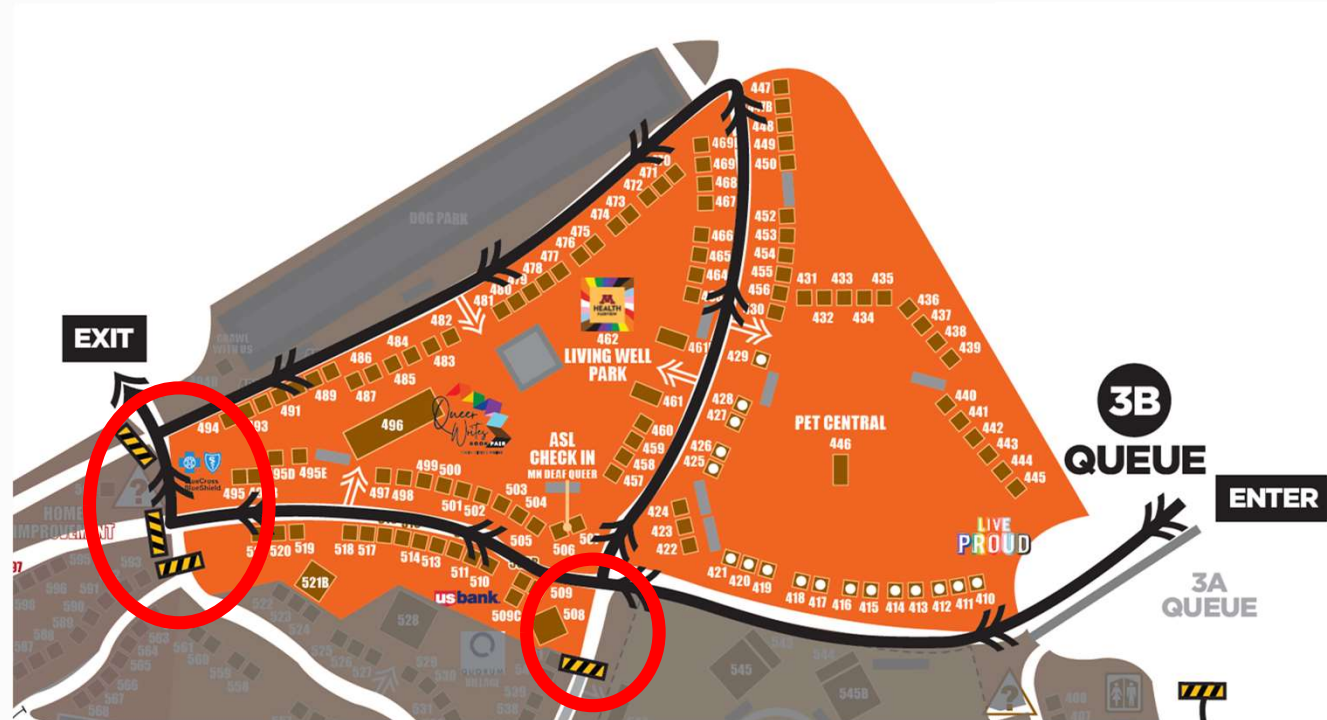

ROUTE 4

Hot Pink: Food ALL HA - HJ
Food Storage FS1-FS4

Route Entry & Queue Map

Directions to get into line (queue) to minimize traffic congestion.

ROUTE 4 ENTRY AND QUEUE

Take Hennepin Ave turning onto Maple Street turning right onto Harmon Place. This is a controlled entry point.

- Food Vendors & Food Storage: Travel to edge of park in parking lot or Sidewalk and WAIT for staff to escort into position in the park.

Maps available at <https://tcpride.org/2025vendorinfo/>



ROUTE 4

Hot Pink: Food ALL HA - HJ
Food Storage FS1-FS4

Load-In Thursday June 26 & Friday 27th

- Food Vendors (Thursday 26th)
- Booth Vendors (Thurs/Fri 26 & 27)
in 2 hour shifts
- Picked a 2 hour window to arrive

Instructions for Load-Out:

- Festival Ends 6 PM
- Cars in at 7 PM

Maps available at <https://tcpride.org/2025vendorinfo/>

Route Load-in/Out Map

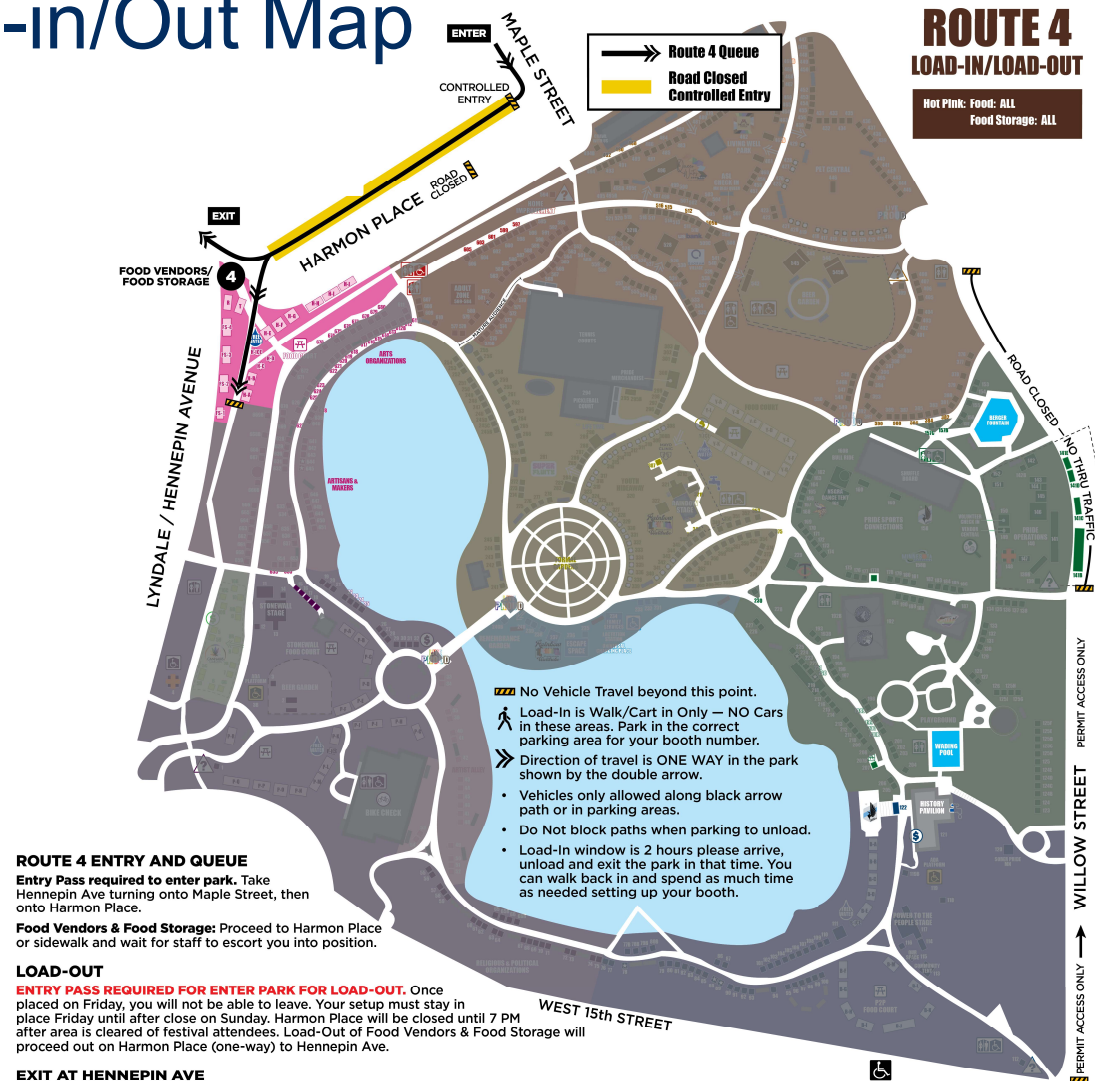

ROUTE 4

Hot Pink: Food ALL HA - HJ
Food Storage FS1-FS4

NOTE:

Food Vendors & Food Storage:
Travel to edge of park in parking lot or Sidewalk (at 4) and WAIT for staff to escort into position in the park.

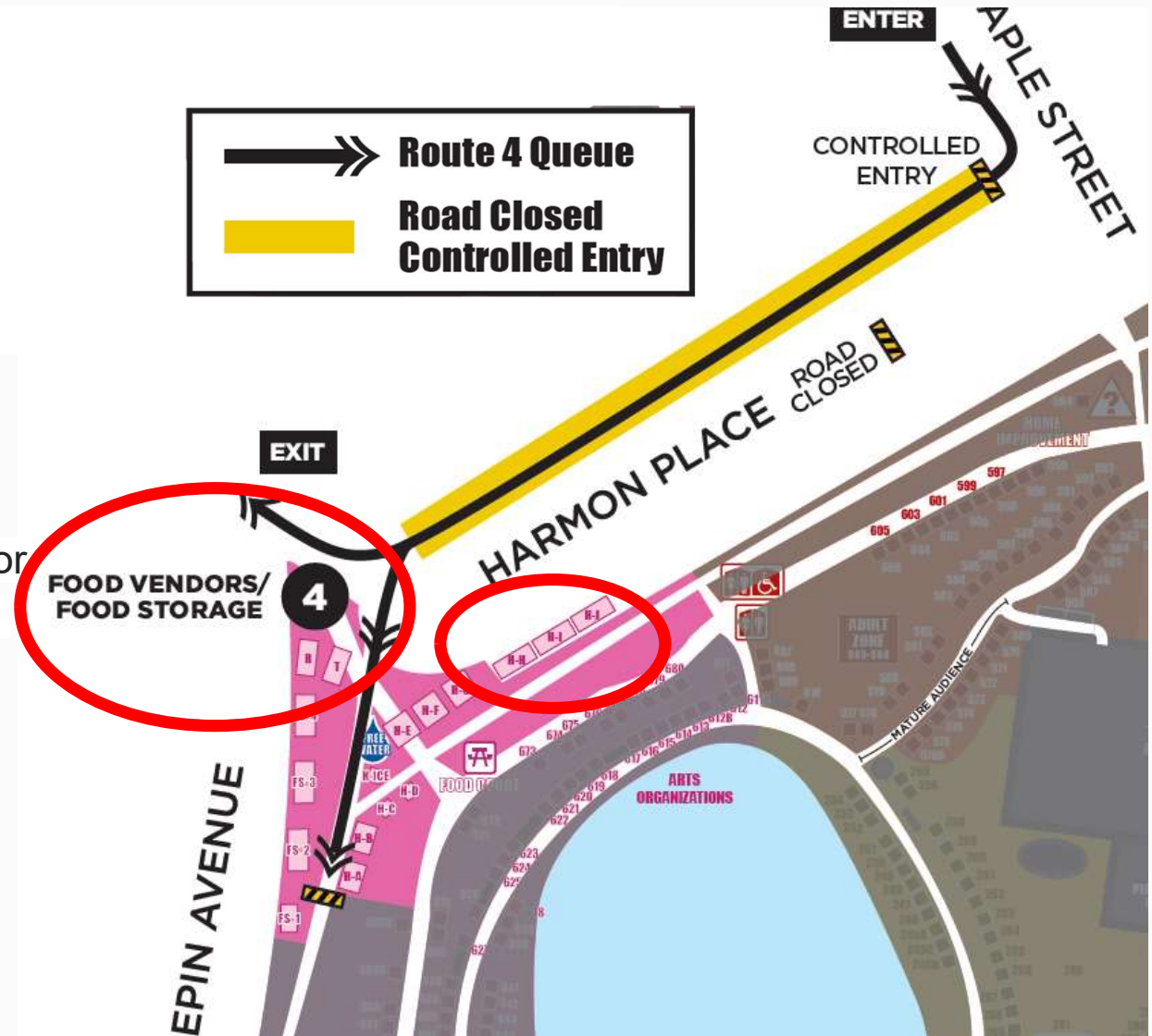



2025 Twin Cities Pride Festival



Load-Out

Sunday 29th & Monday 30th Load Out

RECOMMEND CART OUT IF POSSIBLE

6 PM Festival Ends -

When Crowds are Clear

90% Loading out Sunday Night

7 PM Small Personal Vehicles Enter

8 PM Large Trucks Enter

8 PM Routes 1 & 2 (Purple & Blue)

Food Trucks Begin to Leave

8:30/9 PM Enter / Exit

Entry Pass to get vehicle in the park Sunday Night.
SAME PASS AS LOAD-IN June 26/27th



Sample Entry Pass & Route Queue

NOTE: Needed for Load Out – Store in Booth



Resources for Vendors



[VIDEO: Gender Identity and Pronouns - What Will You Teach The World?](https://youtu.be/J3Fh60GEB5E)
<https://youtu.be/J3Fh60GEB5E>

[Blog Post: How You Can Be an Active Ally](#)

[Blog Post: How to Be an Ally: From Curious to Courageous](#)

PFLAG is an organization that offers support and education for families, friends, and allies of LGBTQ+ individuals.

[Straight for Equality: Becoming a Trans Ally Recording & Training Toolkit](#)
[Supporting Trans & Nonbinary Loved Ones](#)



This deck, route maps, and recordings of sessions available at <https://tcpride.org/2025vendorinfo/>

Questions:
festival@tcpride.org

Q & A

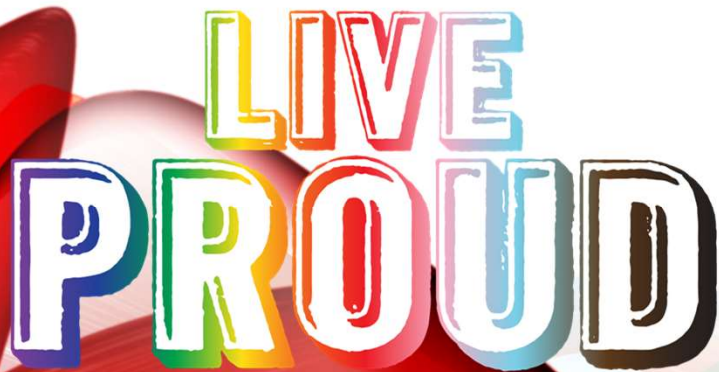
A graphic with the words "LIVE PROUD" in a bold, 3D, blocky font. The letters are multi-colored with a rainbow gradient. The word "LIVE" is smaller and positioned above "PROUD". The letters have a white outline and a slight shadow. The background features a red, wavy, ribbon-like shape on the left and a blue, wavy, ribbon-like shape on the right, both with a glossy, reflective texture.

LIVE
PROUD



Thank you

Please send feedback to festival@tcpride.org

