

ROUTE 2 LOAD-IN/LOAD-OUT

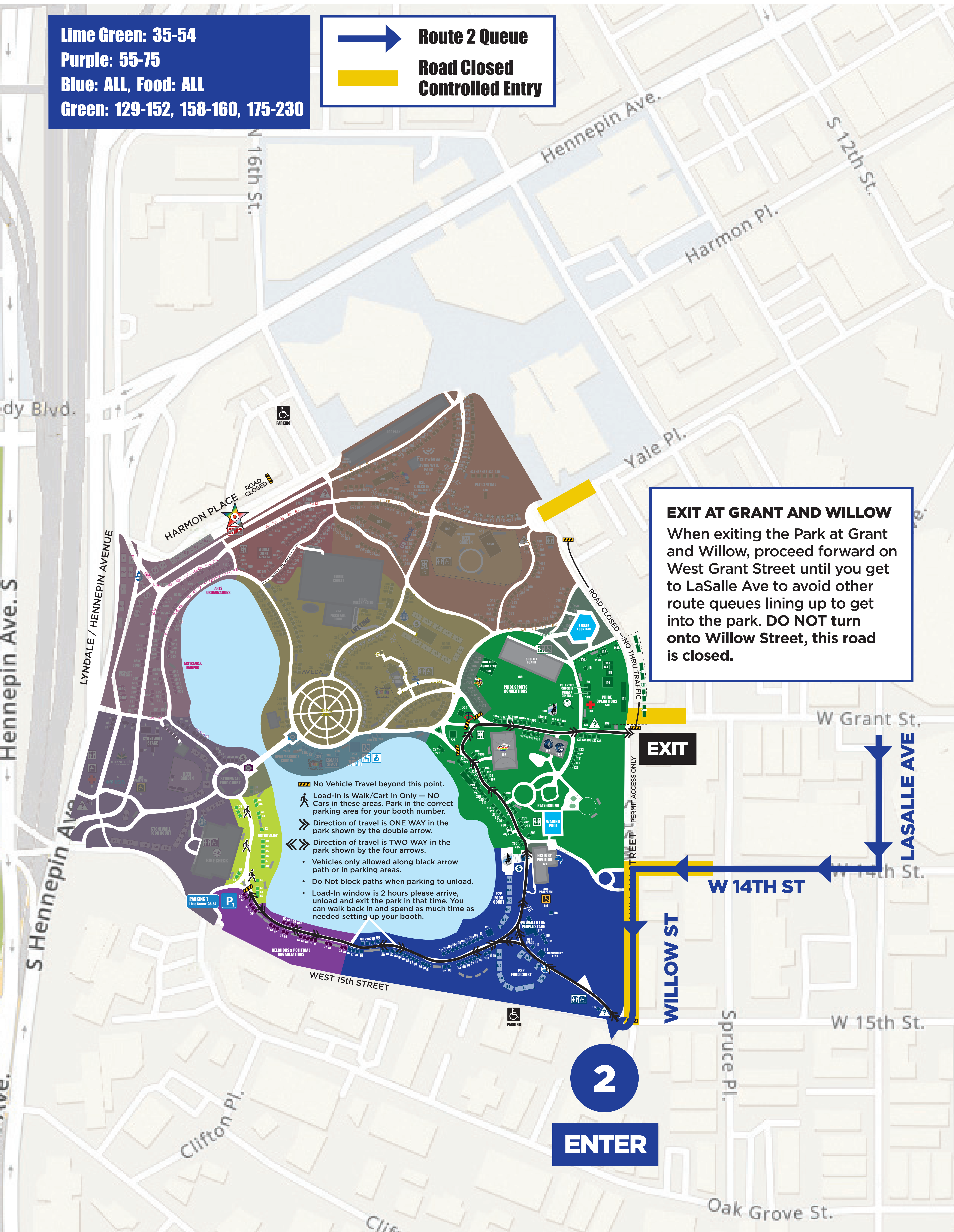





ENTRY AND QUEUE

Entry Pass required to enter park. Take LaSalle Ave to West 14th Street, head westbound toward the Park, enter Controlled Entry for local traffic with Entry Pass, turn left onto Willow go up toward West 15th Street, turn right into Loring Park with Entry Pass before you get to West 15th Street. **DO NOT** attempt to enter into Loring Park from West 15th Street.

Lime Green: 35-54
Purple: 55-75
Blue: ALL, Food: ALL
Green: 129-152, 158-160, 175-230



EXIT AT GRANT AND WILLOW
 When exiting the Park at Grant and Willow, proceed forward on West Grant Street until you get to LaSalle Ave to avoid other route queues lining up to get into the park. **DO NOT** turn onto Willow Street, this road is closed.

-  No Vehicle Travel beyond this point.
-  Load-In is Walk/Cart in Only — NO Cars in these areas. Park in the correct parking area for your booth number.
-  Direction of travel is ONE WAY in the park shown by the double arrow.
-  Direction of travel is TWO WAY in the park shown by the four arrows.
-  Vehicles only allowed along black arrow path or in parking areas.
-  Do Not block paths when parking to unload.
-  Load-In window is 2 hours please arrive, unload and exit the park in that time. You can walk back in and spend as much time as needed setting up your booth.



LOAD-OUT

ENTRY PASS REQUIRED TO ENTER PARK FOR LOAD-OUT. Load-Out Sunday 7-8 PM: Small commercial vehicles are allowed in the park for Load-Out. At 8 PM, entry into the park will stop until Food Trucks have exited under escort at the entry point. All other vehicles should exit according to the flow of traffic indicated by black line and double arrows. Vehicle entry will resume sometime around 9 PM or when Food Trucks have exited.